



D Morgan

**Proposed Development at
New Hey Quarry, Rochdale**

Stage 1 Utility Report

Revision V1

Contents

| | |
|---|----|
| 1 Project Description | 3 |
| 2 Overview | 4 |
| 3 Review of Existing Infrastructure | 5 |
| 3.1 Electricity | 5 |
| 3.1.1 <i>Electricity North West</i> | 5 |
| 3.2 Gas | 6 |
| 3.2.1 <i>Cadent Gas</i> | 6 |
| 3.3 Water | 7 |
| 3.3.1 <i>United Utilities</i> | 7 |
| 3.4 Telecoms | 9 |
| 3.4.1 <i>BT Openreach</i> | 9 |
| 3.4.2 <i>Virgin Media</i> | 9 |
| 4 Development Impact on Existing Infrastructure | 10 |
| 4.1 Electricity | 10 |
| 4.1.1 <i>Electricity North West</i> | 10 |
| 4.2 Gas | 10 |
| 4.2.1 <i>Cadent Gas</i> | 10 |
| 4.3 Water | 10 |
| 4.3.1 <i>United Utilities</i> | 10 |
| 4.4 Telecoms | 11 |
| 4.4.1 <i>BT Openreach</i> | 11 |
| 5 Points of Connection | 12 |
| 5.1 Electricity | 12 |
| 5.1.1 <i>Electricity North West</i> | 12 |
| 5.2 Gas | 13 |
| 5.2.1 <i>Cadent Gas</i> | 13 |
| 5.3 Water | 13 |
| 5.3.1 <i>United Utilities</i> | 13 |
| 6 Summary | 15 |
| APPENDIX 1 - Existing Infrastructure | 16 |
| APPENDIX 2 – Assumed Diversions | 17 |
| APPENDIX 3 – Points of Connection | 18 |

Budget figures provided by TDS Northern Ltd are based on a range of information derived from existing network records and previously secured quotations however TDS Northern do not have access to detailed network information and contractor rates and therefore budget figures should be used as a guide only.

1 Project Description

This Utility Statement has been prepared by Technical and Development Services (Northern) Ltd on behalf of D Morgan in relation to a proposed residential development at the former New Hey Quarry, Rochdale.

The purpose of the report is to identify the impact of the proposed development site on existing electricity, gas, water and telecoms infrastructure and to confirm that capacity is available within the existing utility networks to service the development.

The site consists of circa 400 residential units and is accessed from A460 to the south. The site is bounded by existing greenfield land to the east, north and west and existing dwellings to the south.

The red edge location plan below shows the proposed development area.

The grid reference for centre of the site is: (X:394075 Y: 411957).

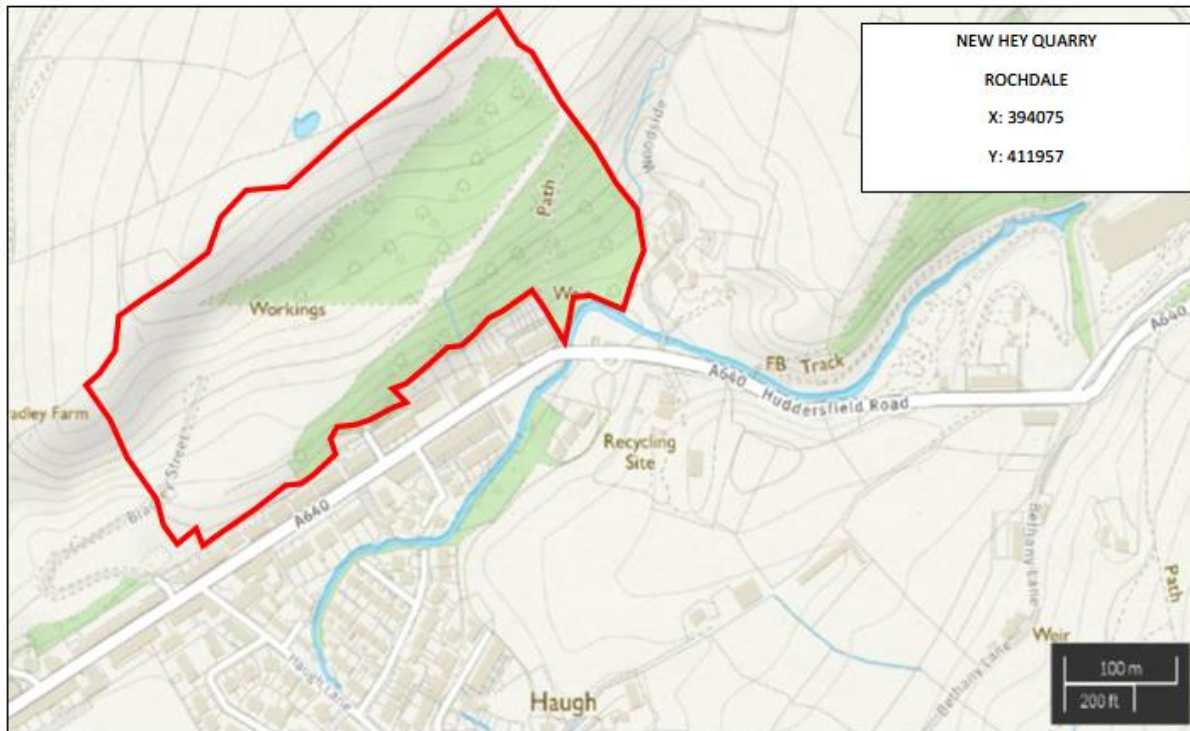

2 Overview

Following a review of the developments effect on existing infrastructure, requirements for proposed infrastructure and relevant applications to utility companies the following overview can be provided. This overview aims to provide clarification of the possible design, programme and cost implications of works required.

| Disconnections | | |
|-----------------------------------|---------------------|-----------------------------|
| Utility | Item | Cost |
| Electricity | N/R | |
| Gas | N/R | |
| Water | N/R | |
| BT Openreach | N/R | |
| Virgin Media | N/R | |
| Diversions | | |
| Utility | Item | Cost |
| Electricity | N/R | |
| Gas | N/R | |
| Water | N/R | |
| BT Openreach | N/R | |
| Virgin Media | N/R | |
| Connections – Offsite Only | | |
| Utility | Item | Cost |
| Electricity | Point of Connection | £21,615.95 |
| | Reinforcement | N/R |
| | Cable Lay to site | £40,800 Budget |
| Gas | Point of Connection | N/R |
| | Reinforcement | N/R |
| | Pipe Lay to site | £10,000 Budget |
| Water | Point of Connection | N/R |
| | Reinforcement | If required £350,000 budget |
| | Pipe Lay to site | £56,400 Budget |

3 Review of Existing Infrastructure

3.1 Electricity

3.1.1 Electricity North West

The existing electricity infrastructure within the vicinity of the site is owned and operated by Electricity North West as a licenced Distribution Network Operator.

The below plan shows existing underground High Voltage and Low Voltage infrastructure.

There is an existing High Voltage network (6.6kV) which runs in an east to west direction along Huddersfield Road on the development side.

There is an existing Low Voltage network which runs in an east to west direction along Huddersfield Road on both sides. This Low Voltage network feeds the surrounding residential properties.

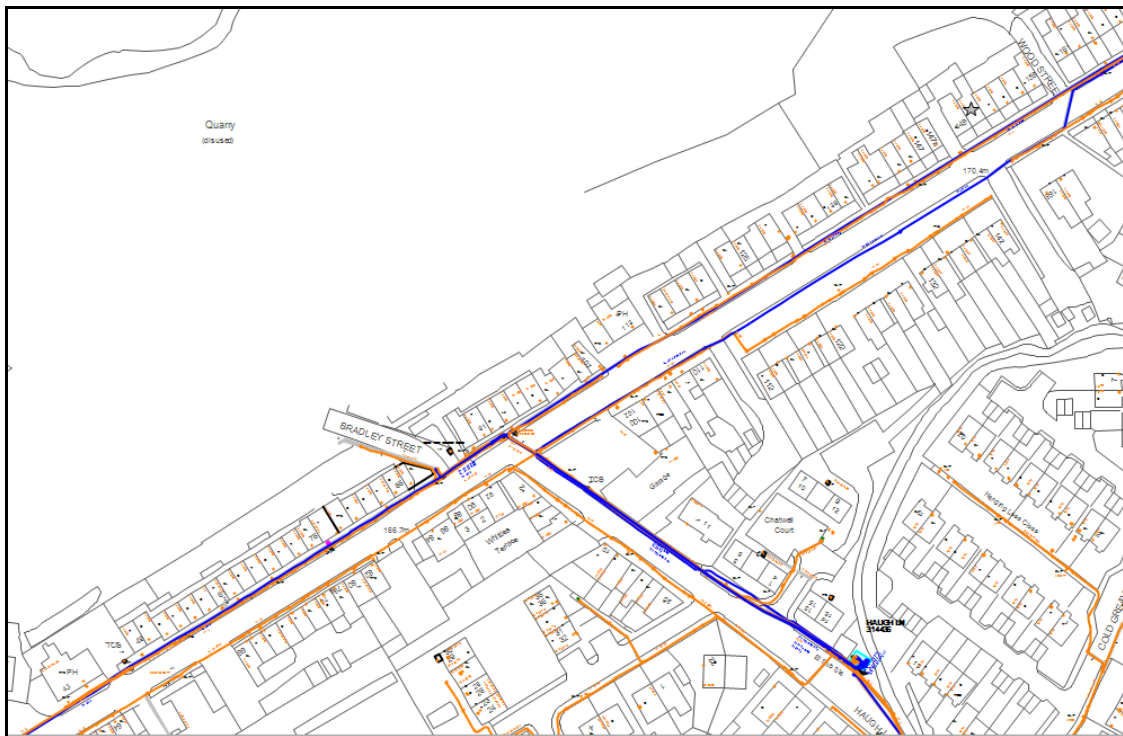

3.2 Gas

3.2.1 Cadent Gas

The existing gas infrastructure within the vicinity of the site is owned and operated by Cadent Gas as a licenced Gas Transporter.

This comprises Low Pressure distribution mains to the South of the proposed site along Huddersfield Road on the development side. Low Pressure infrastructure is shown serving the existing residential properties bordering the site to the South.

A Medium Pressure distribution main also runs along Huddersfield Road, it is shown to be located within the carriageway.

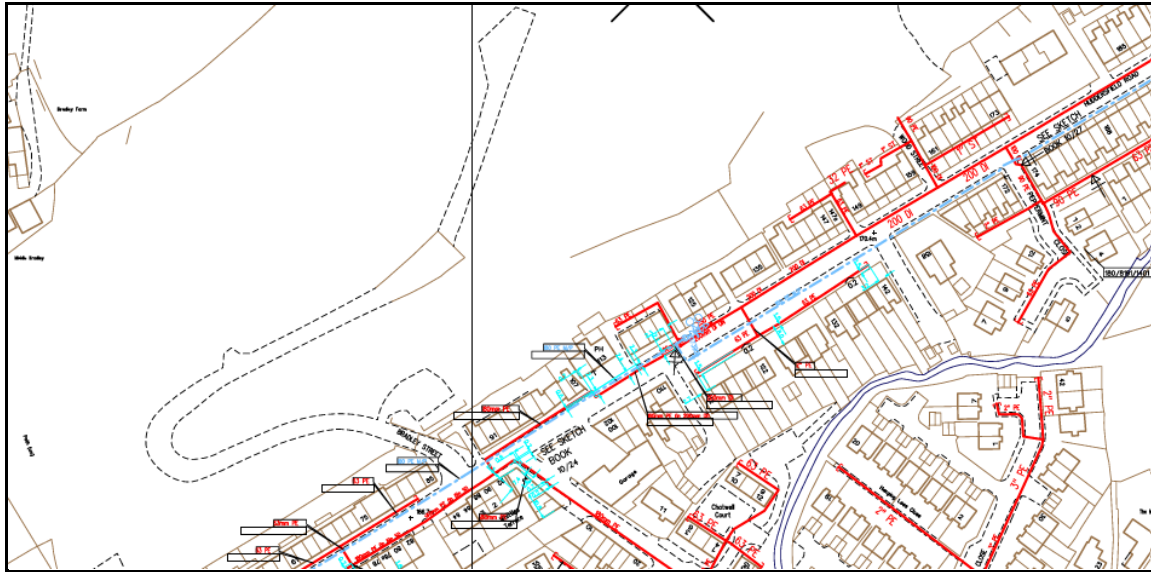

3.3 Water

3.3.1 United Utilities

The existing water infrastructure within the vicinity of the site is owned and operated by United Utilities as a licenced water network operator.

The below plan shows existing 140mm PE main opposite Bradley Street and a 150mm DI main in the vicinity of the site running along Huddersfield Road which serves the existing housing development to the South of the proposed development. There is also a 12" CI raw water main running along Huddersfield Road.

There are existing United Utilities clean water mains within the footpath (development side) of Huddersfield Road for the full extent of the proposed development.

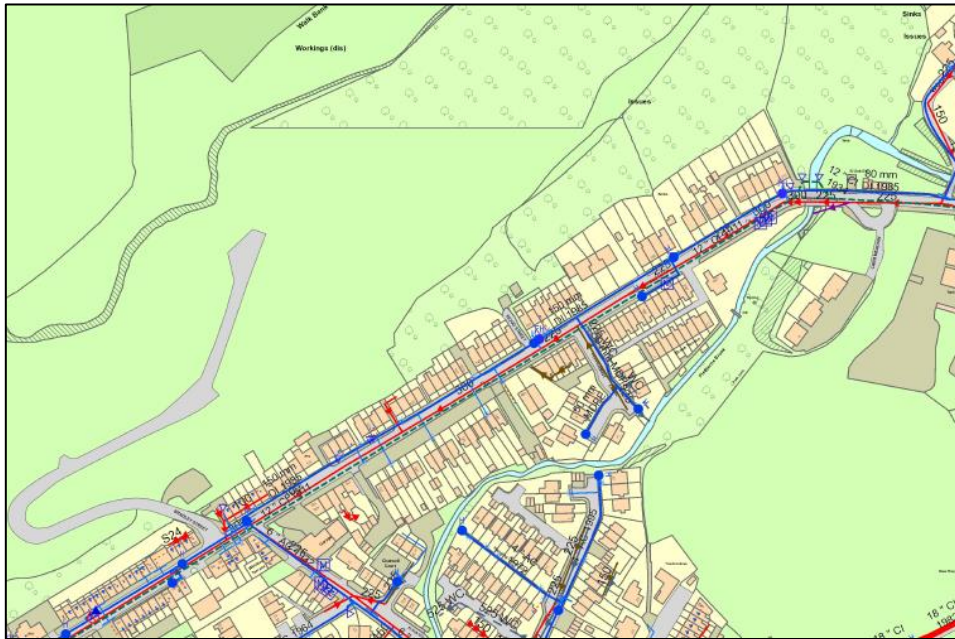

The cleanwater main within the footpath is a 150mm DI main which runs from North East to South West to the front of no. 91 Huddersfield Road.

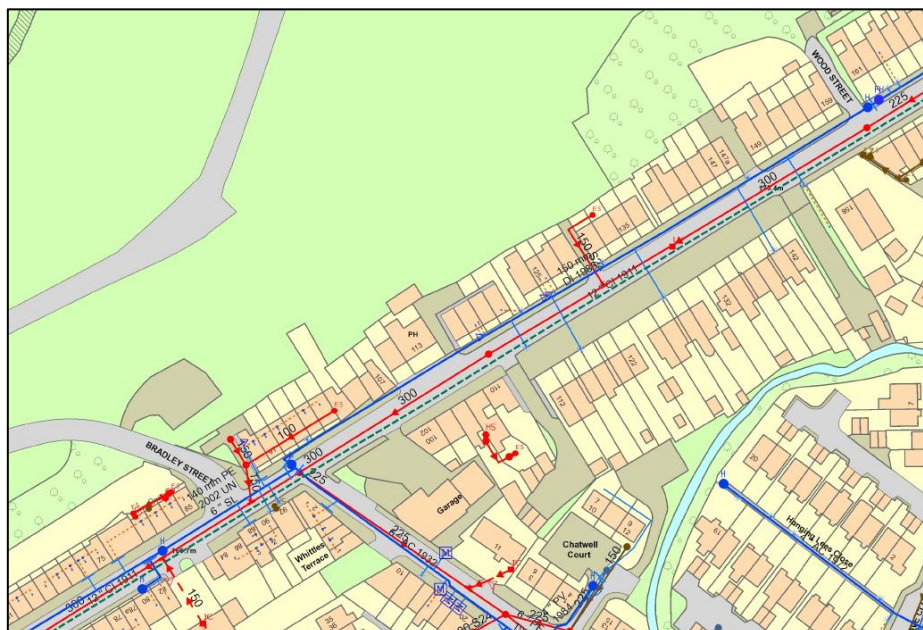

From the front of no. 91 Huddersfield Road, the 150mm DI main runs in the centre of the carriageway and runs South West along Huddersfield Road and also into Haugh Lane.



There is also a 12" raw water main running the length of the site which crosses Peppermint Bridge to the east of 211 Huddersfield Road. This raw water main is in close proximity to the site boundary.

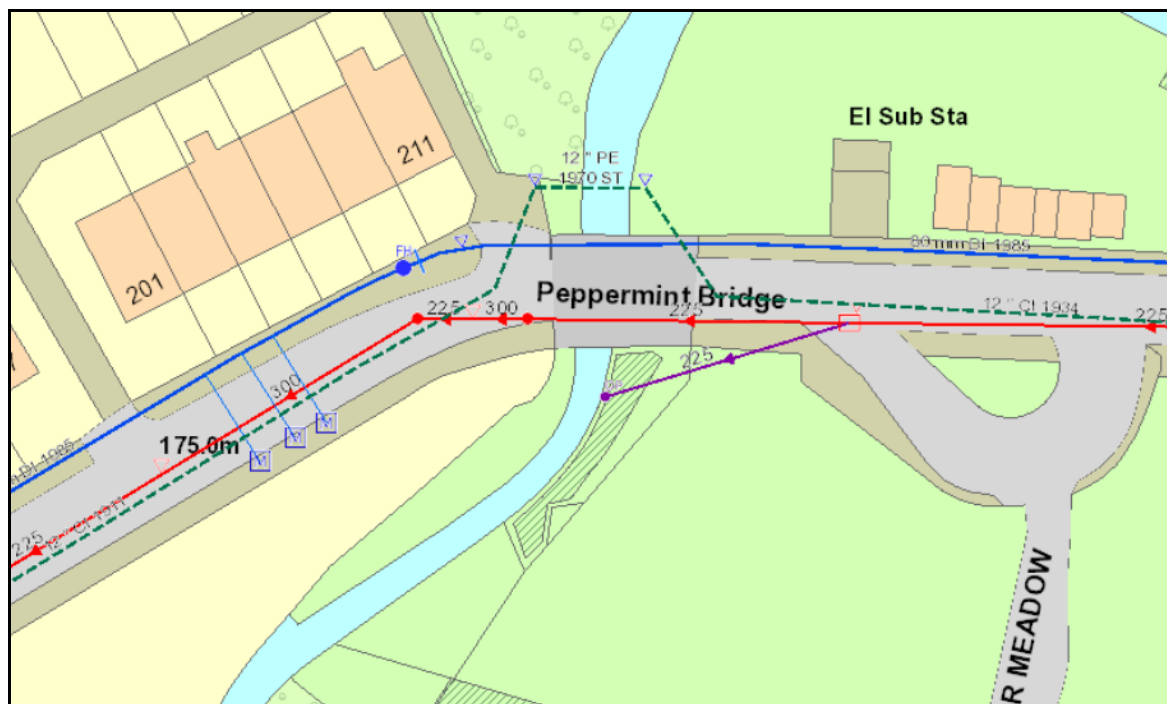

3.4 Telecoms

3.4.1 BT Openreach

BT Openreach own and operate existing telecommunications infrastructure within the vicinity of the proposed site under its rights derived from the telecommunications act.

Openreach infrastructure plans indicate overhead infrastructure within the vicinity of the site to the South serving the existing residential houses from the rear.

Openreach infrastructure plans also indicate underground infrastructure on the opposite side of the road from the development.

The below plans show existing infrastructure records in the vicinity of the site.

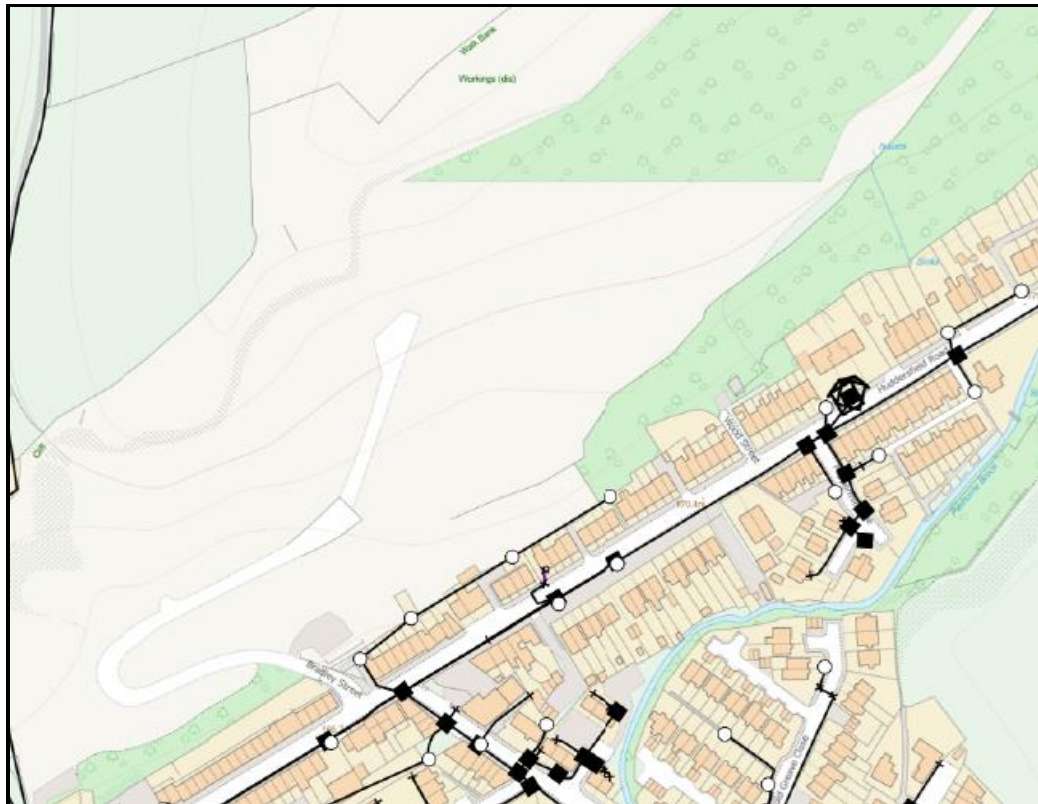

3.4.2 Virgin Media

Virgin Media infrastructure plans do not indicate the presence of any apparatus within the vicinity of the site.

4 Development Impact on Existing Infrastructure

4.1 Electricity

4.1.1 Electricity North West

Existing High voltage and Low voltage underground network is located to the proposed entrance. Also, to the South of the site, there is existing Low Voltage underground network which serves existing local residential properties on the development side.

An application was made to Electricity North West for a diversion and a response was received on the 17th September 2019 (reference 5500155494A) advising that it appears that it will not be necessary to divert any of the existing cables providing that the existing entrance remains unaltered.

The plan below shows the cable records of the approximate positions of all known ENWL apparatus.

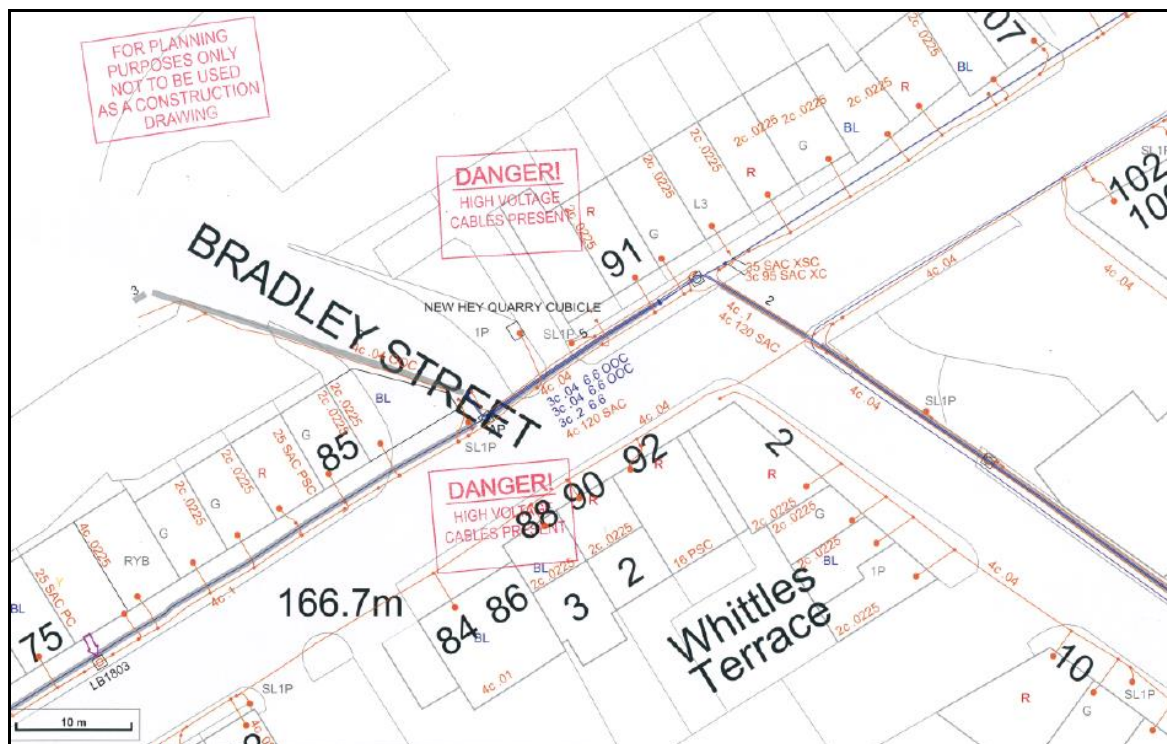

4.2 Gas

4.2.1 Cadent Gas

Due to the position of the infrastructure no diversionary works are anticipated.

4.3 Water

4.3.1 United Utilities

Due to the position of the infrastructure, no diversionary works are anticipated.

4.4 Telecoms

4.4.1 BT Openreach

Due to the position of BT Openreach's infrastructure, a diversion may be required of the overhead poles which run along the edge of the site border.

An application was made to BT Openreach on the 9th July 2019 for a quotation for a diversion of their assets.

A response was received from BT Openreach on the 1st August 2019 (reference 821258) advising that based on the plan submitted, they are unable to confirm if the poles in question will be affected by the development. A more detailed plan for the area showing the interface at the site boundary and the rear of the existing properties will need to be submitted to BT Openreach to enable them to confirm if a diversion is required or not.

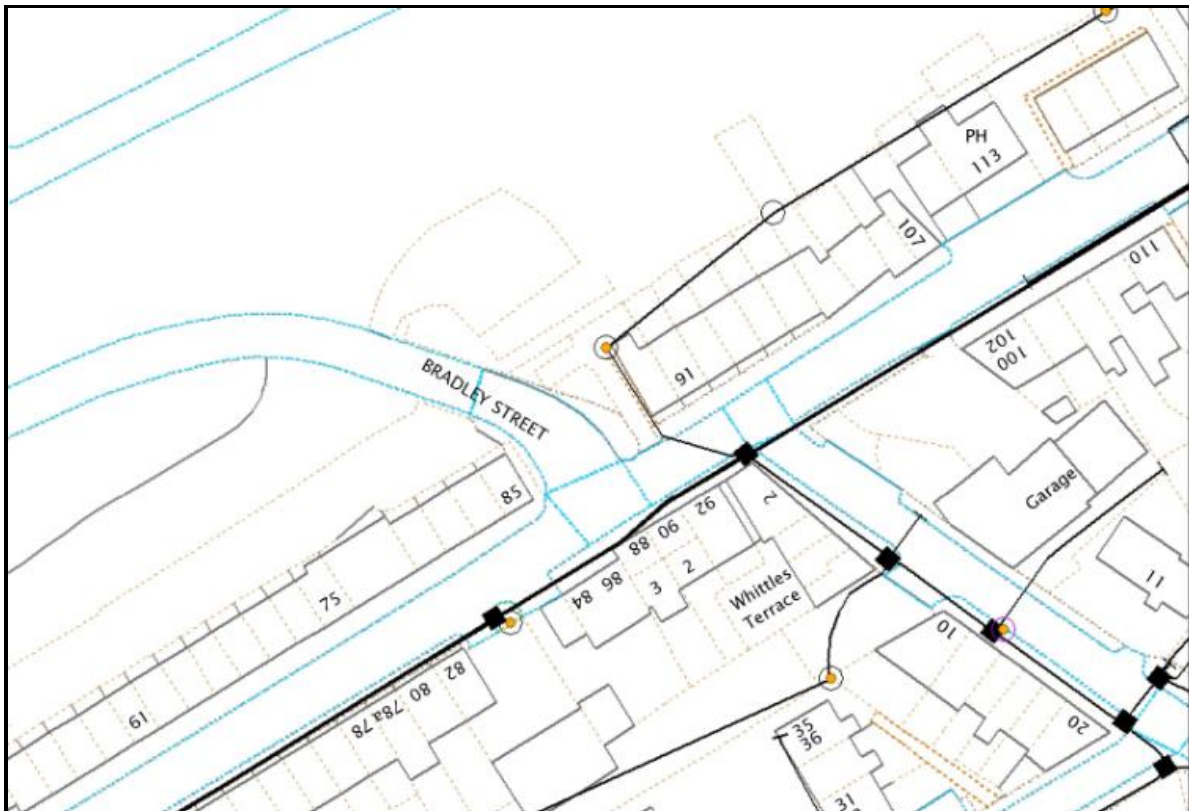

5 Points of Connection

5.1 Electricity

5.1.1 Electricity North West

In order to determine the capacity of the local electricity network to service the site, an application was made to Electricity North West for a point of connection.

A response has been received from Electricity North West dated 10th July 2019 reference 5500153161/A.

A Point of Connection has been identified on the High Voltage Network with a new substation to be looped in to an existing 6.6kV, 3c .25 cable using 3 x 1c300 SAC XLPE cable as shown on the plan below. The new substation to be located in a mutually agreed position. The cost is £21,615.95.

The Point of Connection is approximately 204 metres from the proposed site entrance.

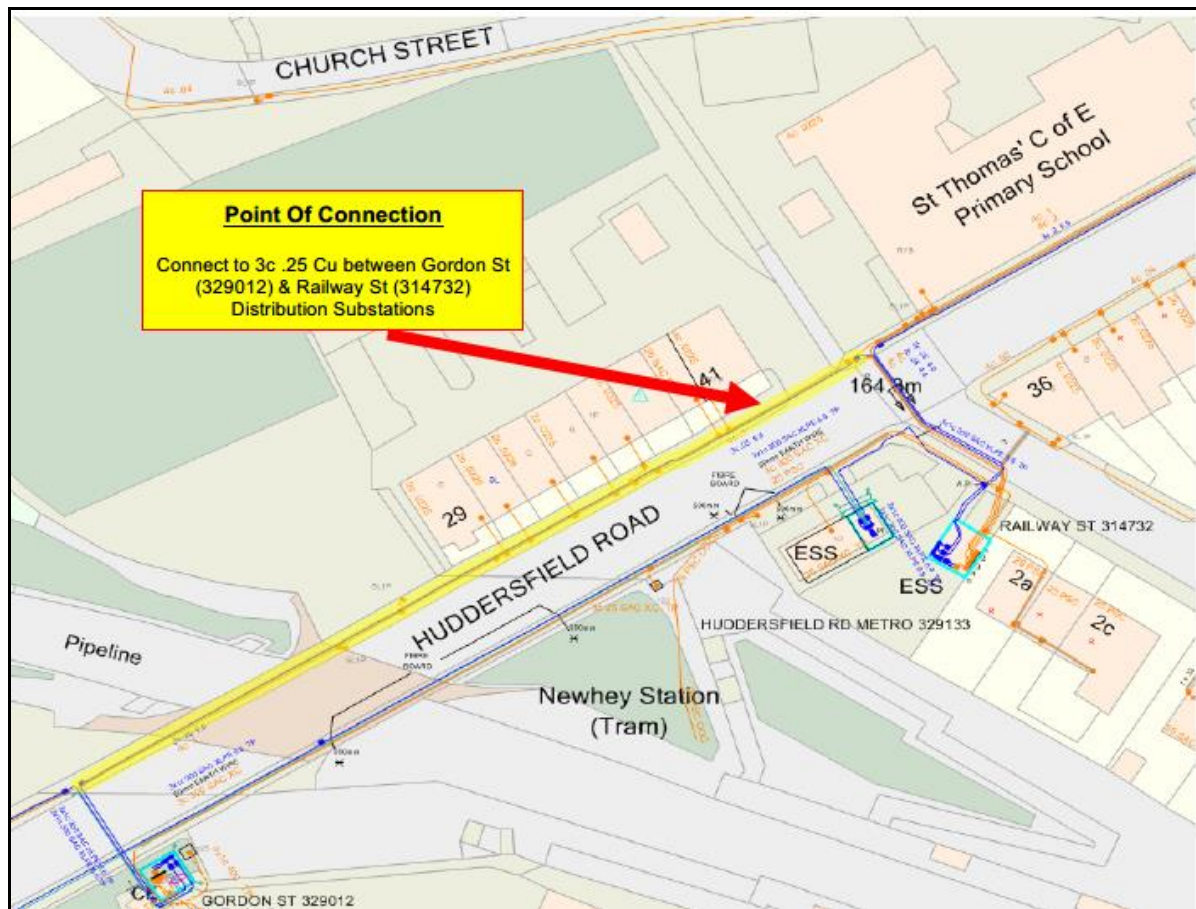

5.2 Gas

5.2.1 Cadent Gas

In order to determine the capacity of the local gas network to service the site, an application was made to Cadent Gas for a land enquiry. A response was received from Cadent Gas on the 1st July 2019 reference 1809911354.

Cadent Gas has advised that the nearest main is 50 metres from the site boundary and it is a 180mm PE Low Pressure main.

The plan below shows the proposed point of connection.

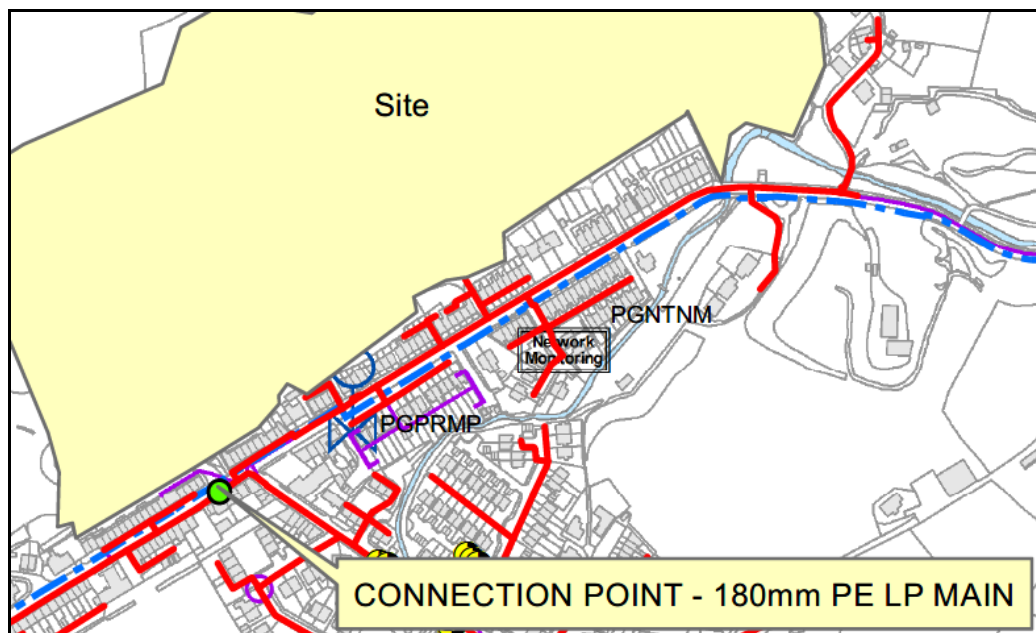

5.3 Water

5.3.1 United Utilities

In order to determine the capacity of the local water network to service the site, an application was made to United Utilities for a pre-development enquiry.

A response was received from United Utilities on the 18th July 2019, reference 4100394429.

The point of connection for the water supply to the development is along a section of the existing 140mm PE Distribution main, located on Haugh Fold, as shown on the plan below. The point of connection is approximately 282 meters in the road at the proposed site entrance.

United Utilities have advised that reinforcement and increased capacity is required. Due to the elevation of the site in relation to the reservoir serving the area, pumps may need to be installed to serve the development. The installation of pumps may be either at the cost of the developer or at the cost of United Utilities dependent upon whether the finished floor level of plots within the site sit above or below the reservoir level. Due to the current information available we are unable to confirm this. A budget figure of £350,000 should be included for a pumping station if required.



6 Summary

It can be concluded from the formal responses received from the host asset owners of the gas, water and electricity infrastructure that all the main utilities are all available within the local area to serve the proposed development. These connection points are within the local road network with minimal impact on the surrounding environment.

The electricity connection will be provided on the High Voltage Network 204 metres from the site boundary. A new substation is required.

The gas point of connection will be to the nearest main which is a 180mm PE Low Pressure and is 50 meters from the site boundary.

The water point of connection will be along a section of the existing 140mm PE Distribution main, located on Haugh Fold. Reinforcement may be required to support the development and it is currently unclear who's responsibility it will be to cover this cost.

Electricity North West have advised that it appears that it will not be necessary to divert any of the existing cables.

No diversions of gas, water and BT Openreach are anticipated.

APPENDIX 1 - Existing Infrastructure

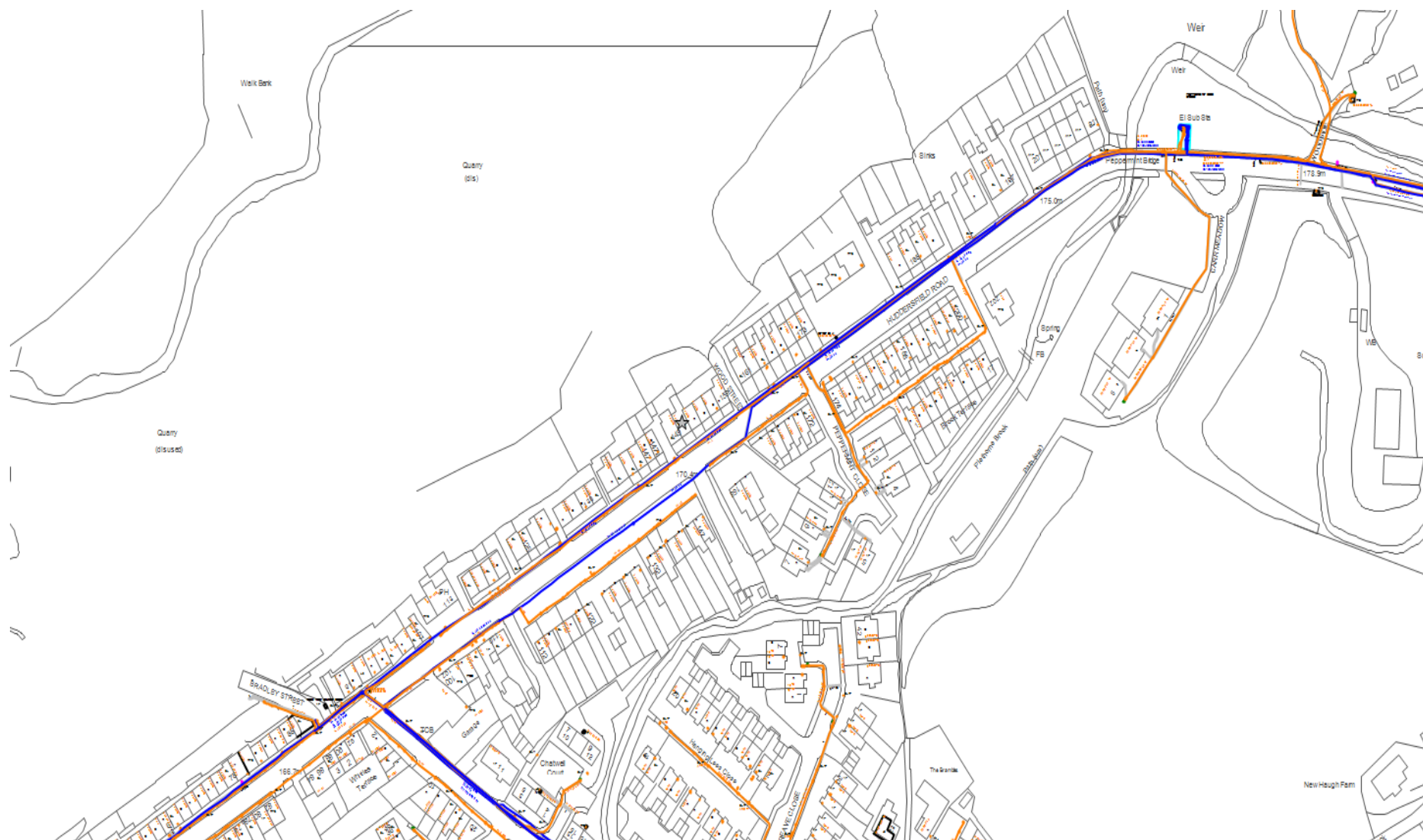

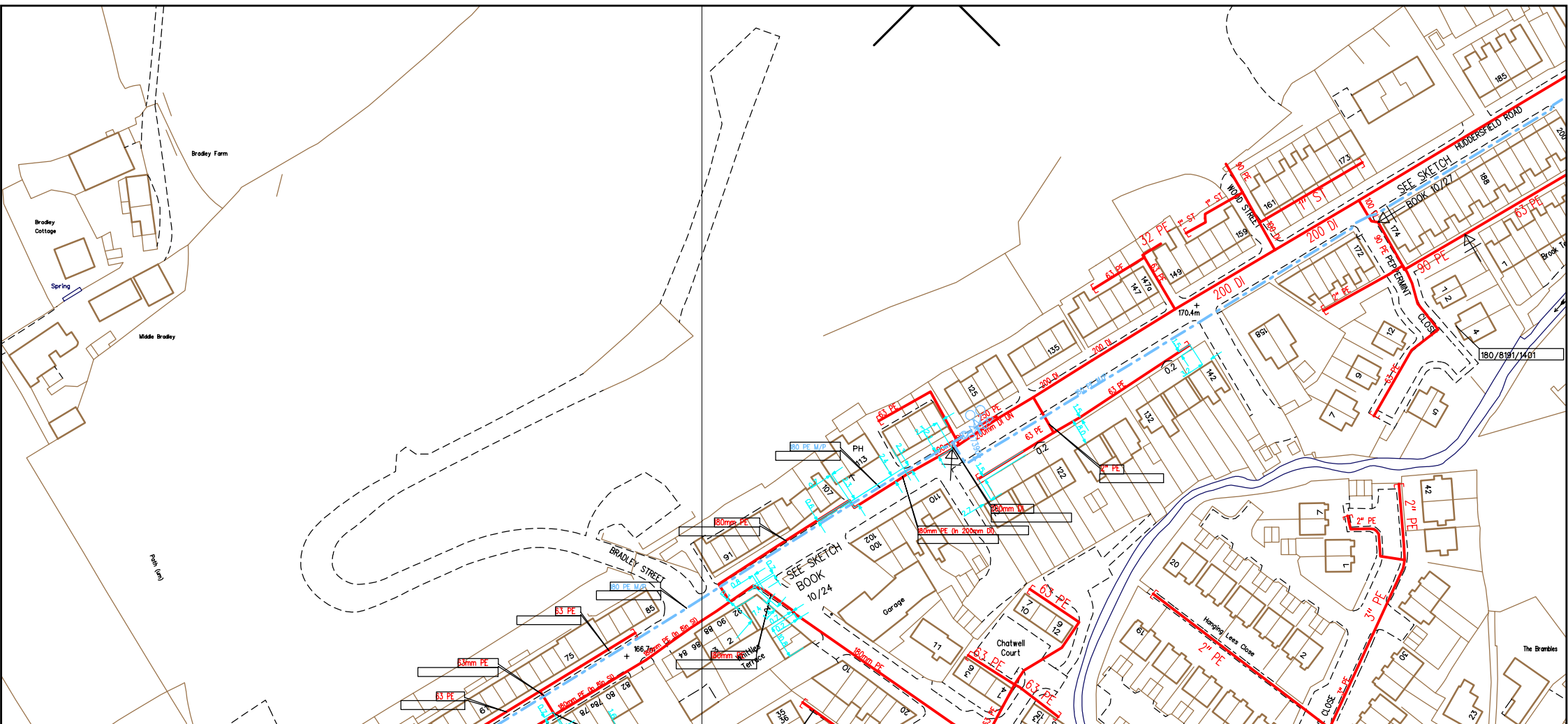

| | | | | |
|--------------------------|--|---|---|-----------------------------|
| SCALE: Not to scale | | <p>LP MAINS MP MAINS IP MAINS LHP MAINS</p> <p>Some examples of Plant Items:</p> <p>Valve Depth of Cover Syphon Diameter Change Material Change Out of Standard Service </p> | <p>This plan shows those pipes owned by Cadent Gas Ltd in their role as a Licensed Gas Transporter (GT). Gas pipes owned by other GTs, or otherwise privately owned, may be present in this area. Information with regard to such pipes should be obtained from the relevant owners. The information shown on this plan is given without warranty, the accuracy thereof cannot be guaranteed. Service pipes, valves, syphons, stub connections, etc. are not shown but their presence should be anticipated. No liability of any kind whatsoever is accepted by Cadent Gas Ltd or their agents, servants or contractors for any error or omission. Safe digging practices, in accordance with HS(G)47, must be used to verify and establish the actual position of mains, pipes, services and other apparatus on site before any mechanical plant is used. It is your responsibility to ensure that this information is provided to all persons (either direct labour or contractors) working for you on or near gas apparatus. The information included on this plan should not be referred to beyond a period of 28 days from the date of issue. Further information on all DR4s can be determined by calling the DR4 hotline on 01455 892426 (9am-5pm) A DR4 is where a potential error has been identified within the asset record and a process is currently underway to investigate and resolve the error as appropriate.</p> | MAPS Viewer Version 5.8.0.1 |
| USER ID: Angela.Brown | | | | Local Machine |
| DATE: 31/10/2019 | | | | |
| EXTRACT DATE: 02/09/2019 | | | | |
| MAP REF: SD9411 | | | | |
| CENTRE: 394026, 411835 | | This plan is reproduced from or based on the OS map by Cadent Gas Ltd, with the sanction of the controller of HM Stationery Office. Crown Copyright Reserved. | | |

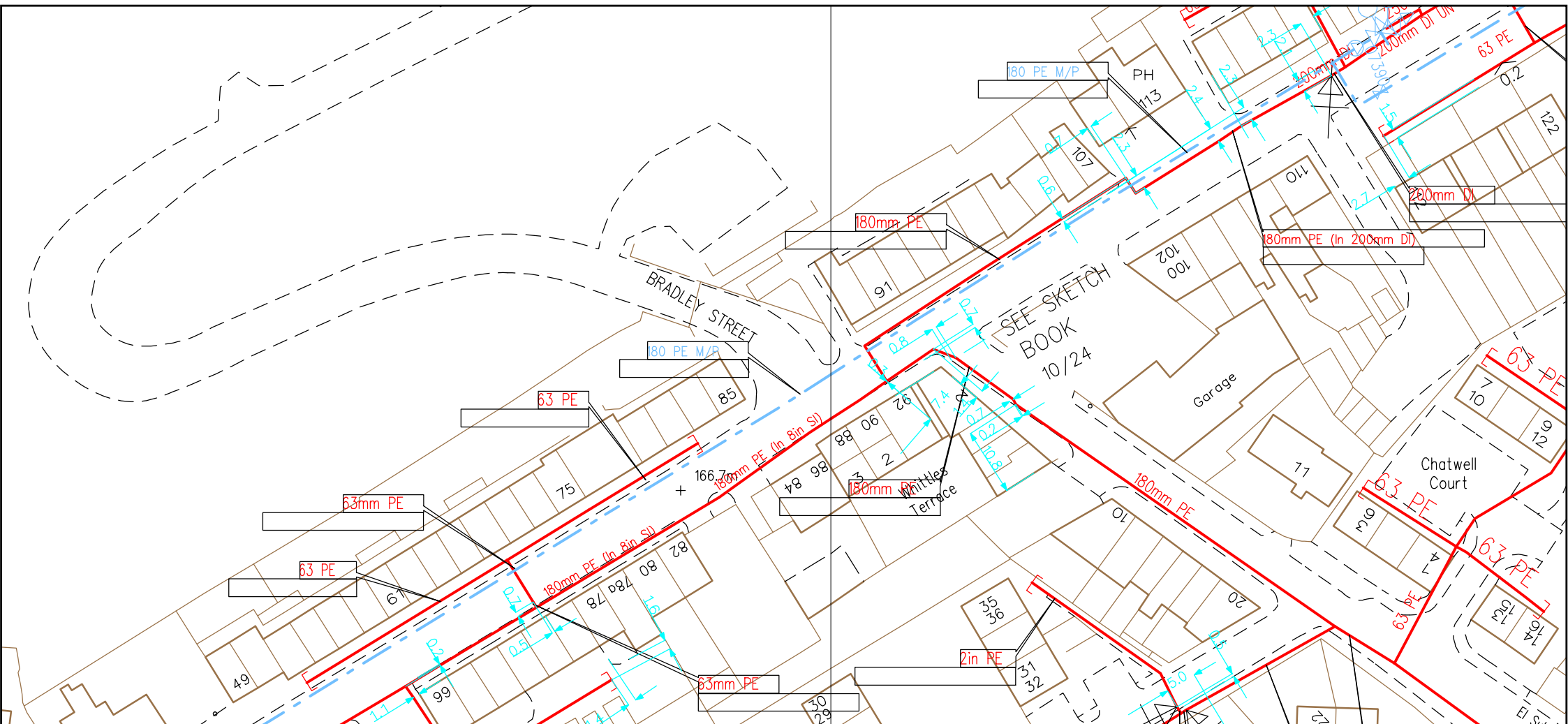

| |
|--------------------------|
| SCALE: Not to scale |
| USER ID: Angela.Brown |
| DATE: 31/10/2019 |
| EXTRACT DATE: 02/09/2019 |
| MAP REF: SD9311 |
| CENTRE: 393992, 411762 |

| | |
|-----------|--|
| LP MAINS | |
| MP MAINS | |
| IP MAINS | |
| LHP MAINS | |

This plan shows those pipes owned by Cadent Gas Ltd in their role as a Licensed Gas Transporter (GT). Gas pipes owned by other GTs, or otherwise privately owned, may be present in this area. Information with regard to such pipes should be obtained from the relevant owners. The information shown on this plan is given without warranty, the accuracy thereof cannot be guaranteed. Service pipes, valves, syphons, stub connections, etc. are not shown but their presence should be anticipated. No liability of any kind whatsoever is accepted by Cadent Gas Ltd or their agents, servants or contractors for any error or omission. Safe digging practices, in accordance with HS(G)47, must be used to verify and establish the actual position of mains, pipes, services and other apparatus on site before any mechanical plant is used. It is your responsibility to ensure that this information is provided to all persons (either direct labour or contractors) working for you on or near gas apparatus. The information included on this plan should not be referred to beyond a period of 28 days from the date of issue. Further information on all DR4s can be determined by calling the DR4 hotline on 01455 892426 (9am-5pm) A DR4 is where a potential error has been identified within the asset record and a process is currently underway to investigate and resolve the error as appropriate.

MAPS Viewer Version 5.8.0.1

Local Machine

This plan is reproduced from or based on the OS map by Cadent Gas Ltd, with the sanction of the controller of HM Stationery Office. Crown Copyright Reserved.

Some examples of Plant Items:

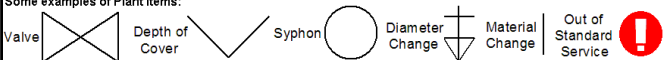

United Utilities Maps for SafeDig

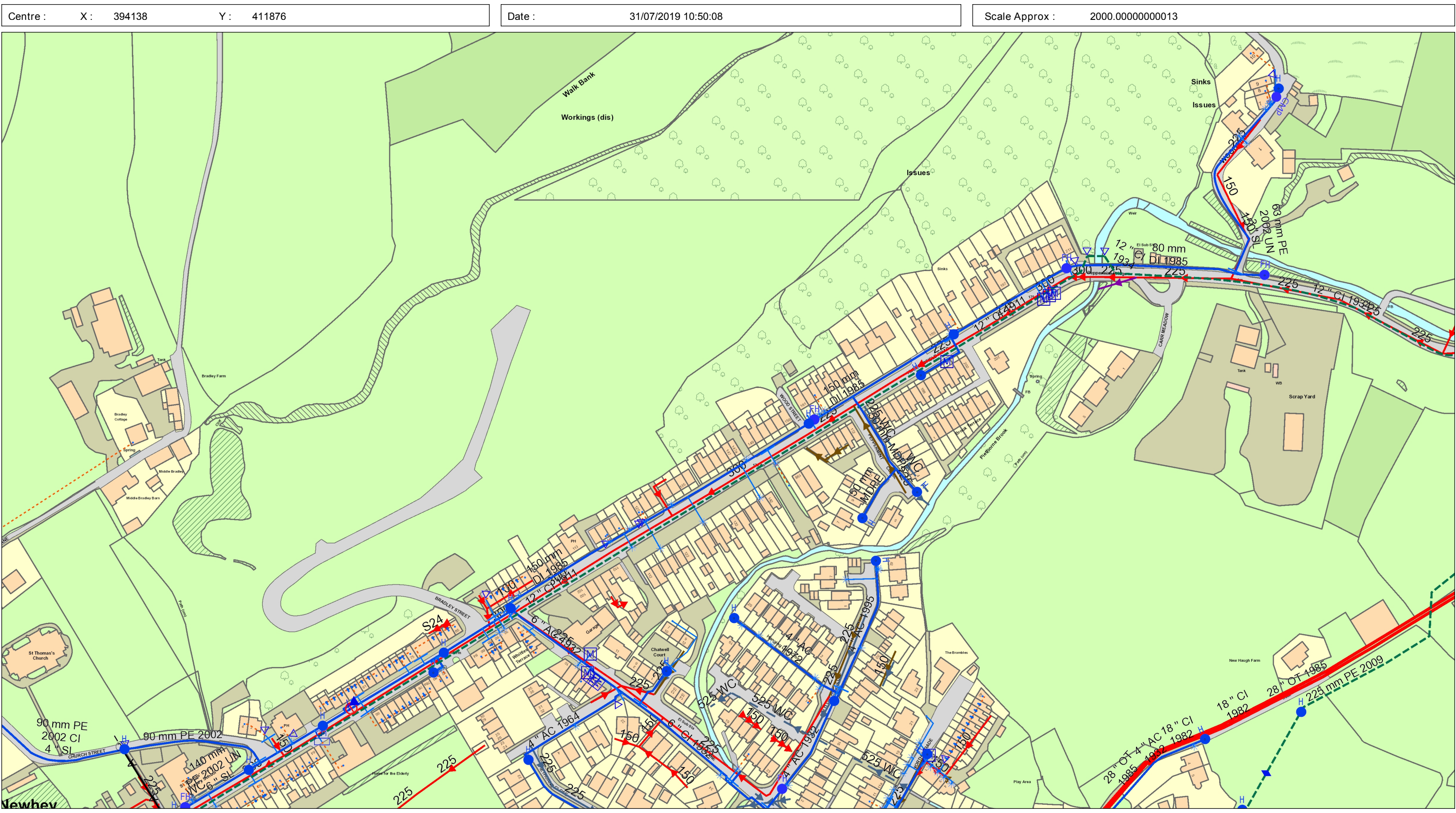

Extract from maps of United Utilities' Underground Assets

Maps by email Plant Information Reply



IMPORTANT WARNING

Information regarding the location of BT apparatus is given for your assistance and is intended for general guidance only. No guarantee is given of its accuracy. It should not be relied upon in the event of excavations or other works being made near to BT apparatus which may exist at various depths and may deviate from the marked route.



openreach

CLICK BEFORE YOU DIG

FOR PROFESSIONAL, FREE-ON-SITE ASSISTANCE PRIOR TO COMMENCEMENT OF EXCAVATION WORKS INCLUDING LOCATE AND MARKING SERVICE

email cbvd@openreach.co.uk

ADVANCE NOTICE REQUIRED
(Office hours: Monday - Friday 08:00 to 17:00)
www.openreach.co.uk/locate

Accidents happen

If you do damage any Openreach equipment please let us know by calling 0800 025 2002 (opt 1 + opt 1) and we can get it fixed ASAP

Reproduced from the Ordnance Survey map by BT
by permission of Ordnance Survey on behalf of the
Controller of Her Majesty's Stationary Office
(C) Crown Copyright British Telecommunications plc 180028048

KEY TO BT SYMBOLS

| Planned | Live | Change Of State | + | Matchings | |
|-------------|----------|--|------------|-----------|--|
| PCP | | Split Coupling | | Split | |
| Pole | | Duct Tee | | Planned | |
| Box | | Building | | Inferred | |
| Manhole | | Woods | | Duct | |
| Cabinet | | Other proposed plant is shown using dashed lines. BT symbols not listed above may be disregarded. Existing BT Plant may not be recorded. Information valid at time of preparation. Maps are only valid for 90 days after the date of publication. | | | |
| Pending Add | In Place | Pending Remove | Not in Use | | |
| Power Cable | | | | | |
| Power Box | | | | | |

BT Ref : INR08539C

Map Reference : (centre) SD9407511957

Easting/Northing : (centre) 394075,411957

Issued : 31/10/2019 08:53:22

WARNING: IF PLANNED WORKS FALL INSIDE HATCHED AREA IT IS ESSENTIAL BEFORE PROCEEDING THAT YOU CONTACT THE NATIONAL NOTICE HANDLING CENTRE OR CASE SEND E-MAIL TO: nch@openreach.co.uk

Maps by email Plant Information Reply

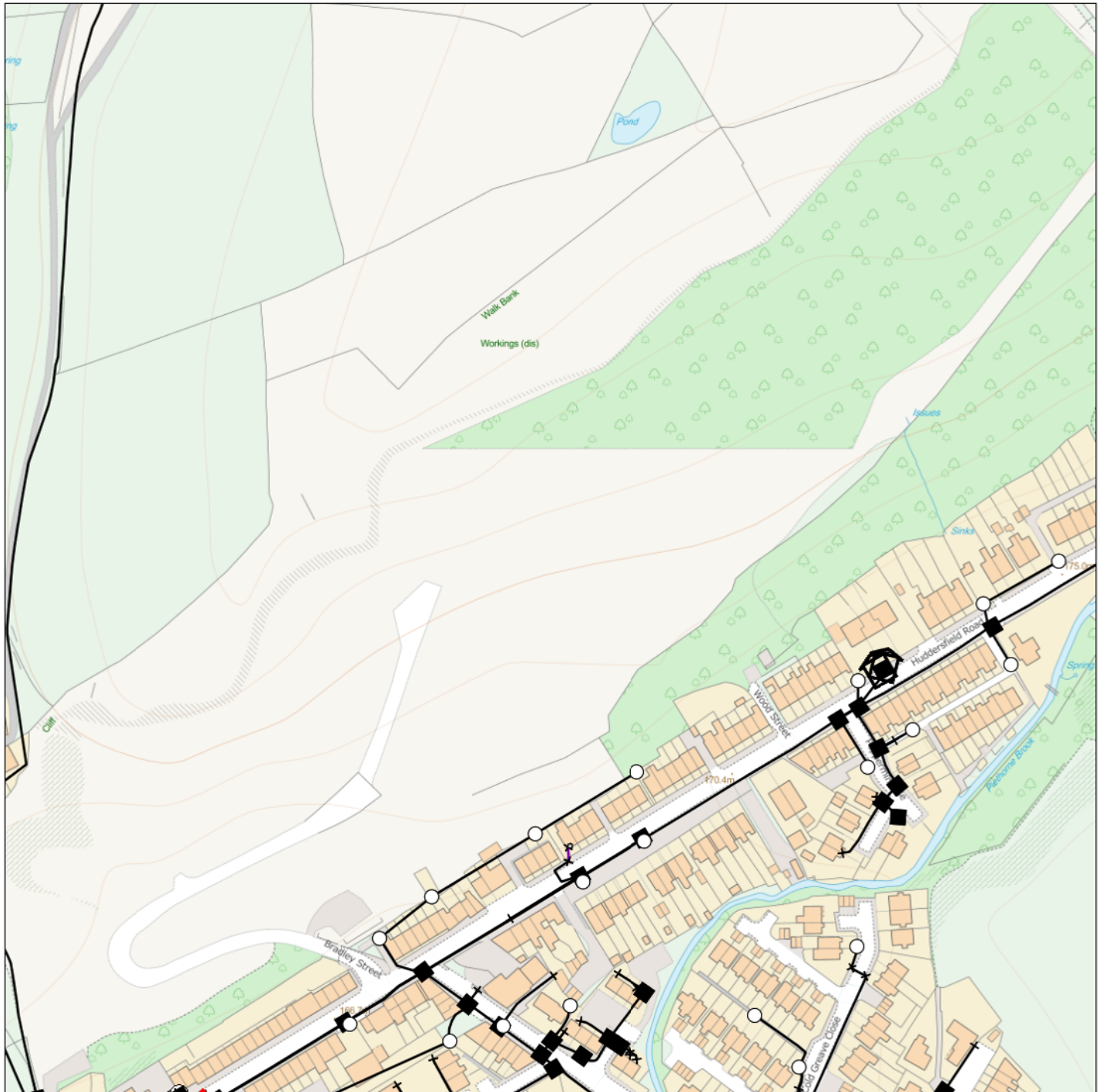

IMPORTANT WARNING

Information regarding the location of BT apparatus is given for your assistance and is intended for general guidance only. No guarantee is given of its accuracy. It should not be relied upon in the event of excavations or other works being made near to BT apparatus which may exist at various depths and may deviate from the marked route.



openreach

CLICK BEFORE YOU DIG

FOR PROFESSIONAL FREE ON SITE ASSISTANCE PRIOR TO COMMENCEMENT OF EXCAVATION WORKS INCLUDING LOCATE AND MARKING SERVICE

email cbyd@openreach.co.uk

ADVANCE NOTICE REQUIRED
(Office hours: Monday - Friday 08.00 to 17.00)
www.openreach.co.uk/cbyd

Accidents happen

If you do damage any Openreach equipment please let us know by calling 0800 023 2023 (opt 1 + opt 1) and we can get it fixed ASAP

KEY TO BT SYMBOLS

| | Planned | Live | Change Of State | + | Hatchings | |
|-------------|-------------|----------|---|------------|-----------|--|
| PCP | | | Split Coupling | | Built | |
| Pole | | | Duct Tee | | Planned | |
| Box | | | Building | | Inferred | |
| Manhole | | | Kiosk | | Duct | |
| Cabinet | | | Other proposed plant is shown using dashed lines. BT Symbols not listed above may be disregarded. Existing BT Plant may not be recorded. Information valid at time of preparation. Maps are only valid for 90 days after the date of publication. | | | |
| | Pending Add | In Place | Pending Remove | Not In Use | | |
| Power Cable | | | | | | |
| Power Duct | | | | N/A | | |

BT Ref : INR08539C

Map Reference : (centre) SD94075 11957

Easting/Northing : (centre) 394075,411957

Issued : 31/10/2019 08:53:22

Reproduced from the Ordnance Survey map by BT by permission of Ordnance Survey on behalf of the Controller of Her Majesty's Stationary Office
(C) Crown Copyright British Telecommunications plc 100028040

WARNING: IF PLANNED WORKS FALL INSIDE HATCHED AREA IT IS ESSENTIAL BEFORE PROCEEDING THAT YOU CONTACT THE NATIONAL NOTICE HANDLING CENTRE. PLEASE SEND E-MAIL TO: nnhc@openreach.co.uk



(c) Crown copyright and database rights 2020 Ordnance Survey 100019209 Date: 20/02/20 Scale: 1:2517 Map Centre: 394056,411863 Data updated: 06/01/20 Telecoms Plan A4

Important Information - please read The purpose of this plan is to identify Virgin Media apparatus. We have tried to make it as accurate as possible but we cannot warrant its accuracy. In addition, we caution that within Virgin Media apparatus there may be instances where mains voltage power cables have been placed inside green, rather than black ducting. Further details can be found using the "Affected Postcodes.pdf", which can be downloaded from this website. Therefore, you must not rely solely on this plan if you are carrying out any excavation or other works in the vicinity of Virgin Media apparatus. The actual position of any underground service must be verified by cable detection equipment, etc. and established on site before any mechanical plant is used. Accordingly, unless it is due to the negligence of Virgin Media, its employees or agents, Virgin Media will not have any liability for any omissions or inaccuracies in the plan or for any loss or damage caused or arising from the use of and/or any reliance on this plan. This plan is produced by Virgin Media Limited (c) Crown copyright and database rights 2020 Ordnance Survey 100019209.

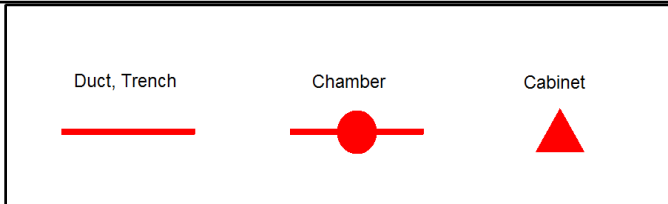

| |
|---------------------------------|
| emma.leffler@gallagherltd.co.uk |
| |
| |



Affected Utilities

Unaffected Utilities

DANGER!
HIGH VOLTAGE
CABLES PRESENT

DANGER!
HIGH VOLTAGE
CABLES PRESENT

Whittles
Terrace

166.7m

Printed By: NULL
Date: 11-Sep-2019
X: 394005
Y: 411764
Scale: 1:250

electricity
north west

Bringing energy to your door

11/09/2019



Northern House,
3A Kennerleys Lane,
Wilmslow,
Cheshire
SK9 5EQ

For the attention of Angela Brown

Our ref: 5500155494 A

Dear Madam,

RE: New Hey Quarry, Rochdale OL16 3QG

In response to your enquiry, I enclose cable records showing the approximate positions of all known Electricity North West Limited's apparatus for the area you specified and would draw your attention to the explanatory notes which have been added to the enclosed plans.

From our interpretation of the information you have provided, it appears that it will not be necessary to divert any of the existing cables.

If you require up to date records, they can be obtained from <http://www.enwl.co.uk/our-services/know-before-you-dig!>

All work in the vicinity of underground electric cables must be in accordance with the requirements of the HSE document HS (G) 47, "Avoiding Danger from Underground Services".

It is particularly important to locate cables using cable avoidance equipment and confirm location by safe digging techniques.

Any work carried out in the vicinity of any overhead conductors by you or your contractors must be carried out in accordance with the requirements of the Health and Safety Executive (HSE) document GS6 "Avoidance of Danger from Overhead Electric Lines".

Please ensure that all your operators are aware of these requirements.

In the event that you discover Electricity North West apparatus and require the cable identifying please contact our operations team on 0800 195 4141.

If, in the course of your site investigations it is discovered that cable diversions are necessary, please do not hesitate to contact this office so that costs can be prepared. Please note that if this situation arises, we require approximately 30 days to provide a design and estimate for the works and then following payment, approximately 8-14 weeks to start work on site depending on local authority restrictions.

If you require any further information or assistance please telephone me on the details provided below.

Kind Regards

Chris Cliff
Design Engineer
Infrastructure Solutions
Electricity North West Limited
Tel No: 08433 114 382
chris.cliff@enwl.co.uk

ANGELA BROWN
TDS
Northern House
3A Kennerleys Lane
Wilmslow
Cheshire
SK9 5EQ

Plant Protection
Cadent
Block 1; Floor 1
Brick Kiln Street
Hinckley
LE10 0NA
E-mail: plantprotection@cadentgas.com
Telephone: +44 (0)800 688588

National Gas Emergency Number:
0800 111 999*

National Grid Electricity Emergency Number:
0800 40 40 90*

* Available 24 hours, 7 days/week.
Calls may be recorded and monitored.

www.cadentgas.com

Date: 26/09/2019
Our Ref: NW_GE1A_3FWP_048782
Your Ref: New Hey Quarry (LS)
RE: Formal Enquiry, Huddersfield Road, Newhey, Rochdale, Greater Manchester, OL16 3QG

Thank you for your enquiry which was received on 26/07/2019.
Please note this response and any attached map(s) are valid for 28 days.

An assessment has been carried out with respect to Cadent Gas Limited, National Grid Electricity Transmission plc's and National Grid Gas Transmission plc's apparatus. Please note it does not cover the items listed in the section "Your Responsibilities and Obligations", including gas service pipes and related apparatus.
For details of Network areas please see the Cadent website (<http://cadentgas.com/Digging-safely/Dial-before-you-dig>) or the enclosed documentation.

Are My Works Affected?

After consultation with our Diversions Section, it is deemed not necessary for any diversionary works to take place. New plans have been generated and sent with this response.

Diversions works are therefore not anticipated.

The contractor should contact Plant Protection before any works are carried out to ensure the apparatus is not affected by any of the proposed works.

Your Responsibilities and Obligations

The "Assessment" Section below outlines the detailed requirements that must be followed when planning or undertaking your scheduled activities at this location.

It is your responsibility to ensure that the information you have submitted is accurate and that all relevant documents including links are provided to all persons (either direct labour or contractors) working for you near Cadent and/or National Grid's apparatus, e.g. as contained within the Construction (Design and Management) Regulations.

This assessment solely relates to Cadent Gas Limited, National Grid Electricity Transmission plc (NGET) and National Grid Gas Transmission plc (NGGT) and apparatus. This assessment does **NOT** include:

- Cadent and/or National Grid's legal interest (easements or wayleaves) in the land which restricts activity in proximity to Cadent and/or National Grid's assets in private land. You must obtain details of any such restrictions from the landowner in the first instance and if in doubt contact Plant Protection.
- Gas service pipes and related apparatus
- Recently installed apparatus
- Apparatus owned by other organisations, e.g. other gas distribution operators, local electricity companies, other utilities, etc.

It is **YOUR** responsibility to take into account whether the items listed above may be present and if they could be affected by your proposed activities. Further "Essential Guidance" in respect of these items can be found on either the [National Grid](#) or [Cadent](#) website.

This communication does not constitute any formal agreement or consent for any proposed development work; either generally or with regard to Cadent and/or National Grid's easements or wayleaves nor any planning or building regulations applications.

Cadent Gas Limited, NGGT and NGET or their agents, servants or contractors do not accept any liability for any losses arising under or in connection with this information. This limit on liability applies to all and any claims in contract, tort (including negligence), misrepresentation (excluding fraudulent misrepresentation), breach of statutory duty or otherwise. This limit on liability does not exclude or restrict liability where prohibited by the law nor does it supersede the express terms of any related agreements.

If you require further assistance please contact the Plant Protection team via e-mail ([click here](#)) or via the contact details at the top of this response.

Yours faithfully

Plant Protection Team

ASSESSMENT

Affected Apparatus

The apparatus that has been identified as being in the vicinity of your proposed works is:

- Low or Medium pressure (below 2 bar) gas pipes and associated equipment. (As a result it is highly likely that there are gas services and associated apparatus in the vicinity)
- Above ground gas sites and equipment

Requirements

BEFORE carrying out any work you must:

- **Note the presence of an Above Ground Installation (AGI) in proximity to your site. You must ensure that you have been contacted by Cadent and/or National Grid prior to undertaking any works within 10m of this site.**
- Carefully read these requirements including the attached guidance documents and maps showing the location of apparatus.
- Contact the landowner and ensure any proposed works in private land do not infringe Cadent and/or National Grid's legal rights (i.e. easements or wayleaves). If the works are in the road or footpath the relevant local authority should be contacted.
- Ensure that all persons, including direct labour and contractors, working for you on or near Cadent and/or National Grid's apparatus follow the requirements of the HSE Guidance Notes HSG47 - 'Avoiding Danger from Underground Services' and GS6 – 'Avoidance of danger from overhead electric power lines'. This guidance can be downloaded free of charge at <http://www.hse.gov.uk>
- In line with the above guidance, verify and establish the actual position of mains, pipes, cables, services and other apparatus on site before any activities are undertaken.

GUIDANCE

Excavating Safely - Avoiding injury when working near gas pipes:

http://www.nationalgrid.com/NR/rdonlyres/2D2EEA97-B213-459C-9A26-18361C6E0B0D/25249/Digsafe_leaflet3e2finalamends061207.pdf

Standard Guidance

Essential Guidance document:

<http://www2.nationalgrid.com/WorkArea/DownloadAsset.aspx?id=8589934982>

General Guidance document:

<http://www2.nationalgrid.com/WorkArea/DownloadAsset.aspx?id=35103>

Excavating Safely in the vicinity of gas pipes guidance (Credit card):

<http://www.nationalgrid.com/NR/rdonlyres/A3D37677-6641-476C-9DDA-E89949052829/44257/ExcavatingSafelyCreditCard.pdf>

Excavating Safely in the vicinity of electricity cables guidance (Credit card):

<http://www.nationalgrid.com/NR/rdonlyres/35DDEC6D-D754-4BA5-AF3C-D607D05A25C2/44858/ExcavatingSafelyCreditCardelectricitycables.pdf>

Copies of all the Guidance Documents can also be downloaded from the [National Grid](#) and [Cadent](#) websites.

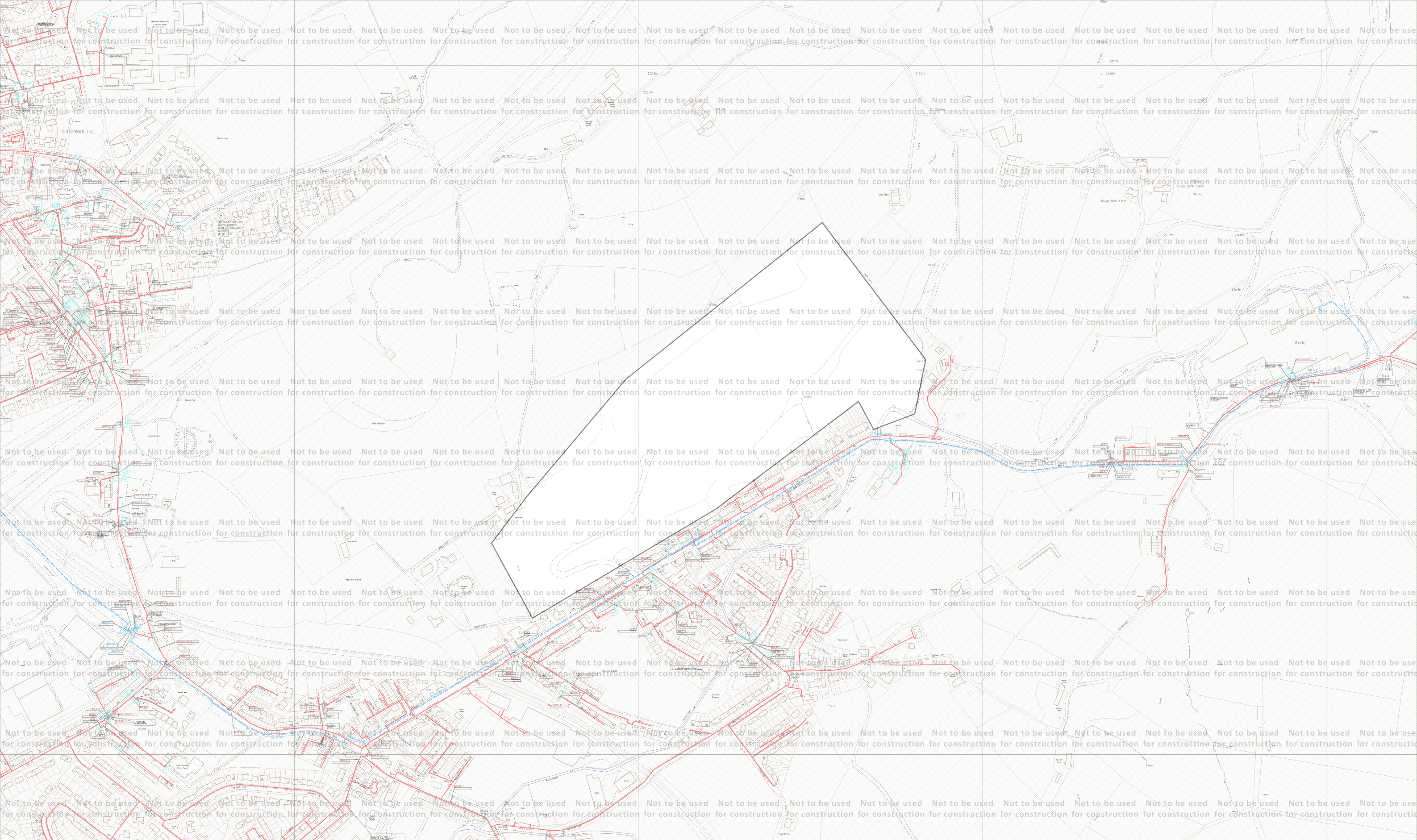

| | | | | | | | |
|-------------------------------|--|---|--|---|--|--|--|
| ID: NW_GE1A_3FWP_048782 | | View extent: 2060m, 1220m | | Cadent and National Grid have withdrawn their objection to this application | | Map 1 of 1 (GAS) | |
| USER: Lauren.Smith | | LP MAINS | | <p>This plan shows those pipes owned by Cadent Gas Limited in its role as a Licensed Gas Transporter (GT). Gas pipes owned by other GTs, or otherwise privately owned, may be present in this area. Information with regard to such pipes should be obtained from the relevant owners. The information shown on this plan is given without warranty, the accuracy thereof cannot be guaranteed. Service pipes, valves, syphons, stub connections, etc., are not shown but their presence should be anticipated. No liability of any kind whatsoever is accepted by Cadent Gas Limited or their agents, servants or contractors for any error or omission. Safe digging practices, in accordance with HS(G)47, must be used to verify and establish the actual position of mains, pipes, services and other apparatus on site before any mechanical plant is used. It is your responsibility to ensure that this information is provided to all persons (either direct labour or contractors) working for you on or near gas apparatus. The information included on this plan should not be referred to beyond a period of 28 days from the date of issue.</p> | | MAPS Plot Server Version 1.11.0 | |
| DATE: 26/09/2019 | | MP MAINS | | | |  Your Gas Network | |
| DATA DATE: 25/09/2019 | | IP MAINS | | | | | |
| REF: New Hey Quarry (LS) | | LHP MAINS | | | | | |
| MAP REF: SD9411 | | NHP MAINS | | | | | |
| CENTRE: 394103, 411985 | | <div>0m100m</div> <div>Approximate scale 1:5000</div> <div>on A3 Colour Landscape</div> | | | | Requested by: TDS | |
| Some examples of Plant Items: | | <div>Valve</div> <div>Depth of Cover</div> <div>Syphon</div> <div>Diameter Change</div> <div>Material Change</div> <div>Out of Standard Service</div> | | | | This plan is reproduced from or based on the OS map by Cadent Gas Limited, with the sanction of the controller of HM Stationery Office. Crown Copyright Reserved. Ordnance Survey Licence number 100024886 | |

ENQUIRY SUMMARY

Received Date

26/07/2019

Your Reference

New Hey Quarry (LS)

Location

Centre Point: 394102, 411985

X Extent: 632

Y Extent: 576

Postcode: OL16 3QG

Location Description: Huddersfield Road, Newhey, Rochdale, Greater Manchester, OL16 3QG

Map Options

Paper Size: A3

Orientation: LANDSCAPE

Requested Scale: 2500

Actual Scale: 1:5000 (GAS)

Real World Extents: 2060m x 1220m (GAS)

Recipients

pprsteam@cadentgas.com

Enquirer Details

Organisation Name: TDS

Contact Name: ANGELA BROWN

Email Address: angela.brown@t-d-s.com

Telephone: 01625462356

Address: Northern House , 3A Kennerleys Lane, Wilmslow, Cheshire , SK9 5EQ

Description of Works

C3 request (e)

Enquiry Type

Formal Enquiry

Activity Type

Development Project

Work Types

Work Type: Deep Excavation (greater than or equal to 0.3m)

Notice Types

Notice Type: NRSWA Diversion Request (C3 Draft Scheme and Budget)





Technical & Development Services
Northern House
3A Kennerleys Lane
Wilmslow
SK9 5EQ

Our Ref: 821258
Your Ref:
Date: 22nd July 2019

FAO: Angela Brown

Dear Sir,

**Diversions of Existing Apparatus at New Hey Quarry
The Electronic Communications (the 2017 code)**

Thank you for your email dated 09/07/19.

I enclose a plan showing the approximate position of Openreach apparatus within your area of interest. Openreach records indicate that no apparatus exists within the area of your proposed works. Please note that a site survey has not been carried out at this stage. Should Openreach apparatus become affected by your works, please contact us so that we can provide you with a necessary cost estimate. Guidance notes attached for your reference.

Please note that our network is being enhanced on a daily basis, therefore, to make absolutely certain no apparatus exists, we recommend you obtain on-site advice and confirmation of the location of Openreach apparatus by contacting the Openreach "Click-Before-You-Dig" Service:

E-mail: cbyd@openreach.co.uk

(Office hours: Monday - Friday 08:00 to 17:00)

Click-Before-You-Dig services are free of charge, but please note that seven working days notice is required for these services.

If you wish to discuss your proposal further, please do not hesitate to contact me.

Yours faithfully,

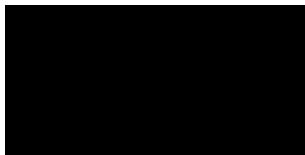

Mark Anderson
Project Engineer

Repayments (Alterations)

PP 519
Dial House
21 Chapel Street
Manchester
M3 7BA

email: mark.6.anderson@openreach.co.uk
tele: 01138074513
mob: 07802 190381

Openreach Limited

Registered Office: Kelvin House
123 Judd Street, London WC1H 9NP
Registered in England and Wales no. 10690039

SPECIAL REQUIREMENTS WHEN WORKING IN THE VICINITY OF OPENREACH APPARATUS

- 1 In this special requirement the following terms shall have these meanings assigned to them:-
 - a) 'Company' means Openreach – a BT Group Company
 - b) 'Company Representative' means the staff of Openreach, or its authorised representatives or Agents
 - c) 'Apparatus' means all boxes, cabinets, poles and plant including any associated cabling and/or ducting owned by Openreach.
- 2 All works in the public highway are subject to the New Roads and Street Works Act 1991, and the Promoter of the work is legally responsible to bear the cost of safeguarding Apparatus. The "highway" includes carriageway, verges, footpaths, etc.
- 3 Before commencing any work, or moving of heavy plant or equipment over any portion of the site the contractor shall confirm details of Apparatus, owned, leased or rented by the Company, within the site, with the Company Representative, who can be contacted for free on site assistance during office hours, prior to commencement of works :-

E-mail : cbyd@openreach.co.uk

Seven working days notice is required.
(Office hours : Monday to Friday 08:00 to 17:00)

Further information is available at:

<http://www.ournetwork.openreach.co.uk/locating-our-network/letting-us-know-about-streetworks.aspx>

Compliance with the above requirements does not relieve the Contractor of any of his obligations under the Contract.

- 4 Apparatus maps are also available at: <http://www.ournetwork.openreach.co.uk/locating-our-network/maps-by-email.aspx>
- 5 Where such details show that the works or the movement of plant or equipment may endanger the Apparatus, the Contractor must give the Company Representative at least 7 days notice of the date on which it is intended to commence such works or the movement of plant or equipment in order that the presence of any sub-surface Apparatus can be indicated by markers to be supplied by the Company and placed by the Contractor under supervision of the Company Representative. The Contractor shall ensure that all Apparatus, particularly surface running cable, is adequately protected from damage and the Engineer shall approve such protective measures.
- 6 In the event of a Company marker being disturbed for any reason it shall not be replaced other than in the exact position and to its former depth unless the repositioning is carried out at the direction and under the supervision of the Company Representative.
- 7 The Contractor shall take particular care in relation to the protection of Apparatus, where such Apparatus includes the presence within the site of optical fibre and/or co-axial cabling. The Contractor shall make every effort to avoid the disturbance of the Company's network which, if damaged, can prove costly to reinstate. The Contractor shall make every effort to avoid the disturbance of Apparatus more than is absolutely necessary for the completion of the works in accordance with the Contract.

When excavating, or backfilling around Apparatus, the Company Representative shall be given adequate notice, which should be not less than 7 days, of the Contractor's intentions in order that he may supervise

the works. The Contractor should note that the normal depth of cover for Apparatus and ducts is as follows :-

- a) in footways 350mm, which is to be maintained
- b) in carriageways 600mm, which is to be maintained.

Where the 350/600mm depth of cover cannot be maintained the Contractor shall carry out the instructions of the Company Representative for the protection of the Apparatus. Where the required depth of cover cannot be maintained over cabling, such cables may have to be diverted.

- 8 All excavation adjacent to Apparatus is to be carried out by hand until the exact extent and/or location of Apparatus is known. Mechanical borers and/or excavators shall not be used within 1.0 metre of Apparatus or 2.0 metres of any pole without the supervisory presence of a Company Representative. To prevent any movement of Apparatus during excavation, complete shuttering shall be used as directed by the Engineer if :-
- a) excavation is deeper than the depth of cover of adjacent Apparatus
 - b) excavation is within 1.0 metre of Apparatus in stable soil
 - c) excavation is within 5.0 metres of Apparatus in unstable soil

If for completion of the works the Contractor intends using any of the following: -

- a) pile driving equipment within 10.0 metres of Apparatus
- b) explosives within 20.0 metres of Apparatus
- c) laser equipment within 10.0 metres of Apparatus

- the Contractor shall advise the Company Representative, in writing, in order that any special protective measures for the Apparatus affected may be arranged.

- 9 All Company manhole, joint box and/or other access points and chambers within the site shall be kept clear and unobstructed. Access for vehicles, winches, cable drums and/or any further equipment required by the Company for the maintenance of its Apparatus must be maintained at all reasonable times. The Contractor should particularly note the footway type chambers are not specified for carriageway loading and will need to be adequately protected and/or demolished and rebuilt under supervision of a Company Representative where such chambers are likely to be placed at risk, either temporarily or permanently, from the movement of plant and/or equipment on the site. The Company Representative shall be given reasonable access to all Apparatus and chambers when required. Where OPENREACH installs Apparatus during the works this new Apparatus shall be treated as existing Apparatus for the purpose of these Special Requirements.
- 10 For Frame and Covers that necessitate a change in level please contact the local office. If you wish to provide recessed frames and covers they will have to be supplied by the Company's agreed supplier. The Contractor must be prepared to supply and install such frames and covers in future, and must supply names of who will be liable for future maintenance.
- 11 In the event of any damage whatsoever to Apparatus the Contractor must immediately inform BT and report the occurrence as follows :-

Call Openreach fault reporting on: 0800 0232023

WARNING

Entry into all Openreach underground structures is prohibited to all unauthorised personnel.

Maps by email Plant Information Reply



IMPORTANT WARNING

Information regarding the location of BT apparatus is given for your assistance and is intended for general guidance only. No guarantee is given of its accuracy. It should not be relied upon in the event of excavations or other works being made near to BT apparatus which may exist at various depths and may deviate from the marked route.



openreach

CLICK BEFORE YOU DIG

FOR PROFESSIONAL FREE ON SITE ASSISTANCE PRIOR TO COMMENCEMENT OF EXCAVATION WORKS INCLUDING LOCATE AND MARKING SERVICE

email cbvd@openreach.co.uk

ADVANCE NOTICE REQUIRED
(Office hours: Monday - Friday 08.00 to 17.00)
www.openreach.co.uk/click

Reproduced from the Ordnance Survey map by BT by permission of Ordnance Survey on behalf of the Controller of Her Majesty's Stationary Office
(C) Crown Copyright British Telecommunications plc 100028040

KEY TO BT SYMBOLS

| | Planned | Live | Change Of State | + | Workings | |
|-------------|-------------|----------|---|------------|----------|--|
| PCR | | | Split Coupling | X | Bolt | |
| Pole | | | Dead Tree | * | Planned | |
| Box | | | Building | | Inferred | |
| Manhole | | | Block | K | Duct | |
| Cabinet | | | Other proposed plant is shown using dashed lines. BT Symbols not listed above may be disregarded. Existing BT plant may not be recorded. Information valid at time of preparation. Maps are only valid for 90 days after the date of publication. | | | |
| | Pending Add | In Place | Pending Remove | Not In Use | | |
| Power Cable | | | | | | |
| Power Duct | | | | N/A | | |

BT Ref : COO12166T

Map Reference : (centre) SD9415411869

Easting/Northing : (centre) 394154,411869

Issued : 18/06/2019 12:17:04

WARNING: IF PLANNED WORKS FALL INSIDE HATCHED AREA IT IS ESSENTIAL BEFORE PROCEEDING THAT YOU CONTACT THE NATIONAL NOTICE HANDLING CENTRE. PLEASE SEND E-MAIL TO: nnhs@openreach.co.uk

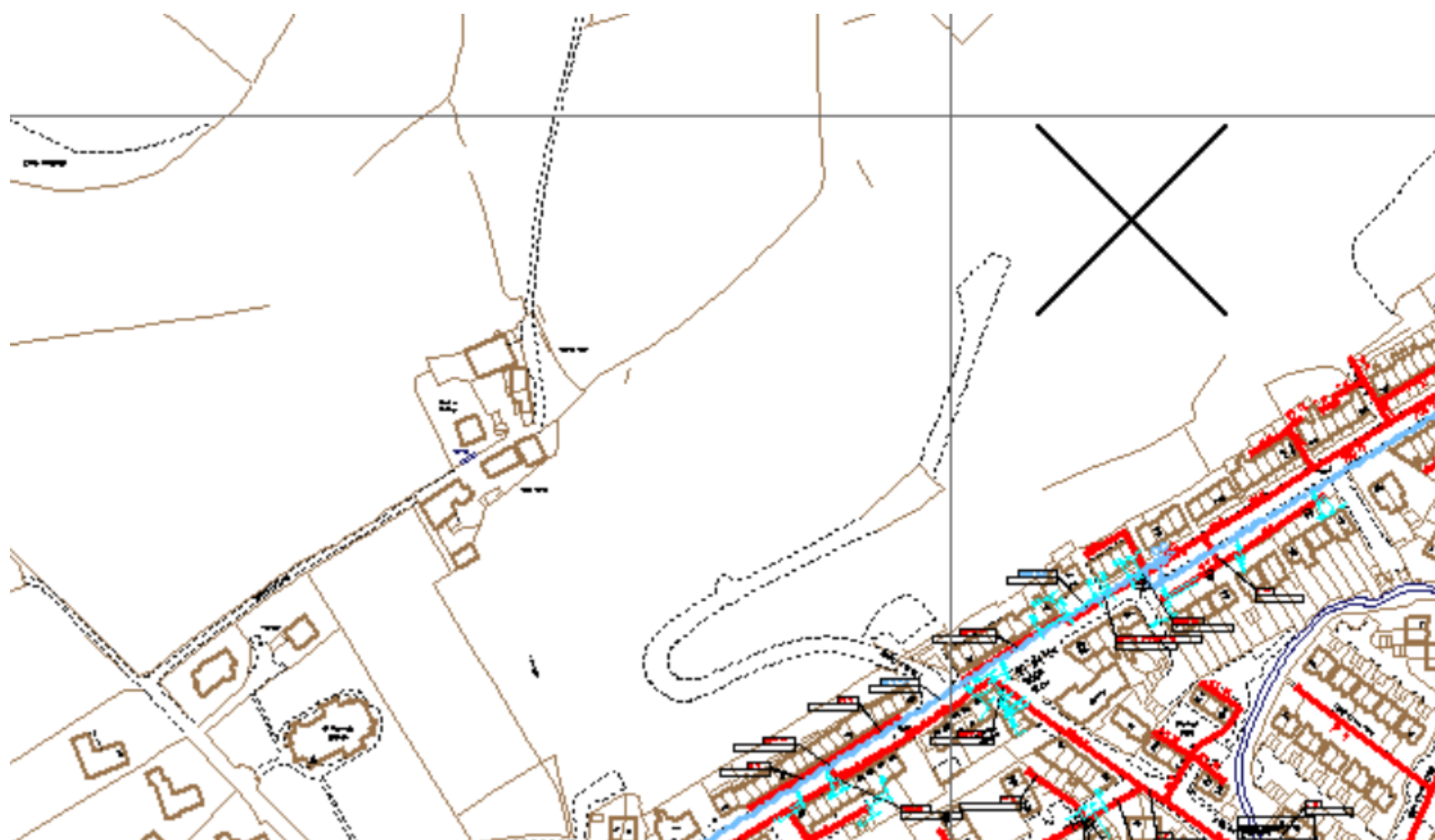

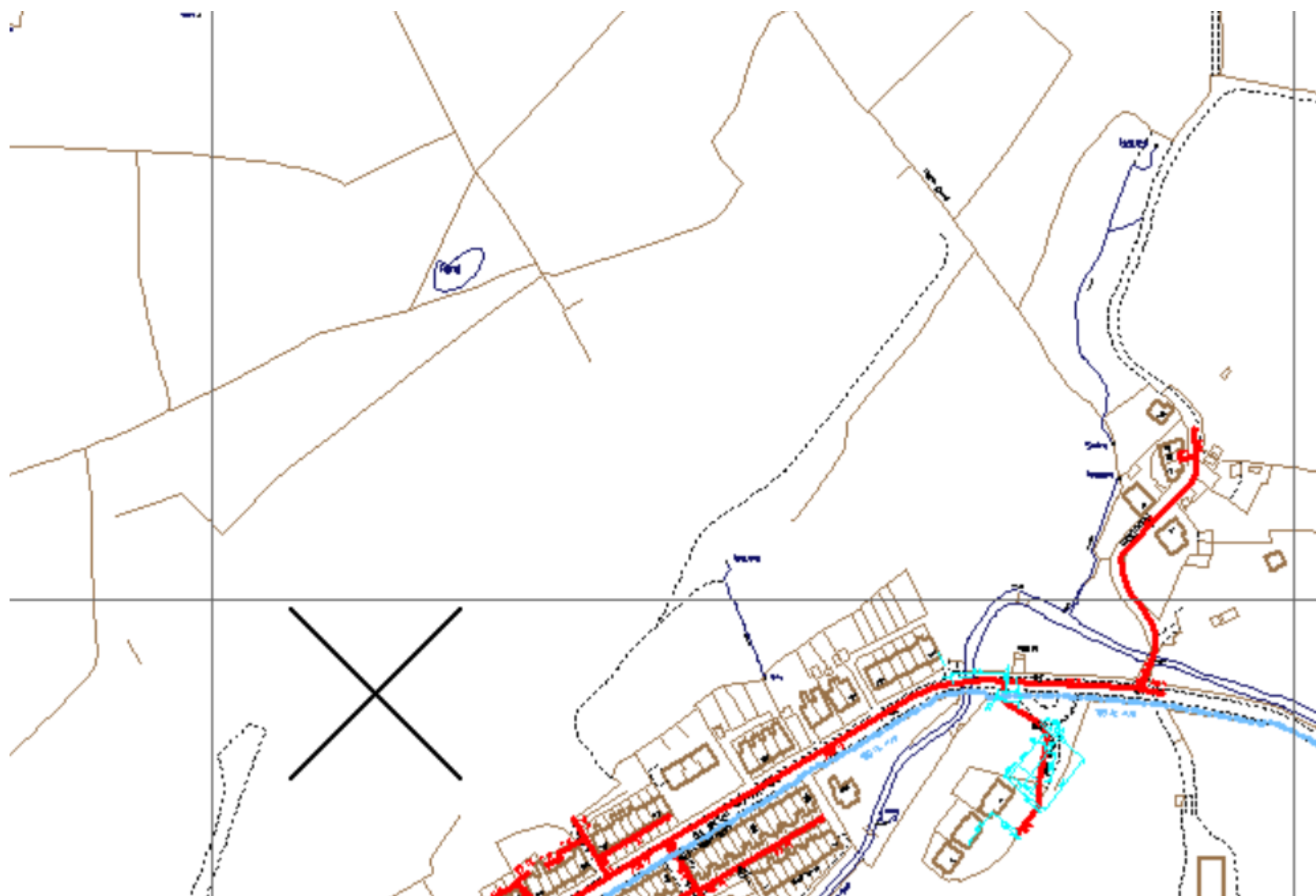



bitmap_layout select_raster

LEGEND

- EXISTING PLANT
- EXISTING PLANT

bitmap_layout select_raster

Head Office
CityFibre Holdings Ltd
15 Bedford Street,
London,
WC2E 9HE
Tel: 0845 293 0774
Web: www.cityfibre.com

Asset Office
CityFibre Holdings Ltd,
Rutherford House,
Birchwood,
Warrington,
WA3 6ZH
Email: asset.team@cityfibre.com

Disclaimer:

Information shown on this plan is for general guidance only. No warranty is made as to its accuracy. This plan must not be solely relied upon in the event of excavation or other works being carried out in the vicinity of Cityfibre plant. No liability of any kind is accepted by Cityfibre, its agents or servants for any error, omission, discrepancy or deviation. This information is valid for the date printed.

Project
Plant Enquiry

Drawing
Existing Plant

Drawn by:
smallworld
Date: 25/06/2019

Drawing No.
CFH_EP_000001
Revision
001

Scale: 1:2500
A4
0m 20m 40m 60m 80m 100m
N

From: Plantenquiries <plantenquiries@catelecomuk.com>

Sent: 28 June 2019 11:37

To: Angela Brown <angela.brown@t-d-s.com>

Subject: RE: Linesearch - Proposed Development - New Hey Quarry, Rochdale.

Please Note: Our search criteria has changed. We previously searched for Colt Network which was within 200 metres, this has now changed to 50 metres. The negative response will be for all enquiries that the network is 50 metres or more away from the place of enquiry.

Dear Sir/Madam,

Thank you for your enquiry for the above reference.

We can confirm that Colt Technology Services do not have apparatus near the above location as presented on your submitted plan, if any development or scheme amendments fall outside the 50 metre perimeter new plans must be submitted for review.

Search is based on Overseeing Organisation Agent data supplied; we do not accept responsibility for O.O. Agent inaccurate data.

If we can be of any further assistance please do not hesitate to contact us.

Kind regards,

Plant Enquiry Team



Please consider the environment before printing this email.

This e-mail and any files transmitted with it are confidential and are intended solely for the use of the intended recipient(s). If you are not the intended recipient, you must not copy, distribute or take any action based on this communication. If you have received this communication in error please contact plantenquiries@catelecomuk.com and delete this communication and any copies of it. Any views or opinions presented are solely those of the author and do not necessarily represent those of C A Telecom LTD. C A Telecom LTD monitors e-mails to ensure that its systems operate effectively and to minimise the risk of viruses.

From: Plantenquiries <plantenquiries@catelecomuk.com>

Sent: 19 June 2019 12:32

To: Angela Brown <angela.brown@t-d-s.com>

Subject: RE: Linesearch - Proposed Development - former Bryn Awel Hotel, Denbigh Road, Mold, CH7 1BL.

Please Note: Our search criteria has changed. We previously searched for Colt Network which was within 200 metres, this has now changed to 50 metres. The negative response will be for all enquiries that the network is 50 metres or more away from the place of enquiry.

Dear Sir/Madam,

Thank you for your enquiry for the above reference.

We can confirm that Colt Technology Services do not have apparatus near the above location as presented on your submitted plan, if any development or scheme amendments fall outside the 50 metre perimeter new plans must be submitted for review.

Search is based on Overseeing Organisation Agent data supplied; we do not accept responsibility for O.O. Agent inaccurate data.

If we can be of any further assistance please do not hesitate to contact us.

Kind regards,

Plant Enquiry Team



Please consider the environment before printing this email.

This e-mail and any files transmitted with it are confidential and are intended solely for the use of the intended recipient(s). If you are not the intended recipient, you must not copy, distribute or take any action based on this communication. If you have received this communication in error please contact plantenquiries@catelecomuk.com and delete this communication and any copies of it. Any views or opinions presented are solely those of the author and do not necessarily represent those of C A Telecom LTD. C A Telecom LTD monitors e-mails to ensure that its systems operate effectively and to minimise the risk of viruses.

From: Plant Enquiries <plantenquiries@energetics-uk.com>

Sent: 25 June 2019 11:59

To: Angela Brown <angela.brown@t-d-s.com>

Subject: RE: Linesearch - Proposed Development - New Hey Quarry, Rochdale.

Dear Sir/Madam,

Thank you for submitting your recent plant enquiry.

Based on the information provided, I can confirm that Energetics **does not** have any plant within the area(s) specified in your request.

If you require further assistance with outstanding enquiries, please call 03300 587 443.

Please ensure all plant enquiries are sent to plantenquiries@energetics-uk.com

Regards



Plant Enquiries

|

e: plantenquiries@energetics-uk.com | **w:** www.energetics-uk.com

a Fenick House, Lister Way, Hamilton International Technology Park, Glasgow, G72 0FT

: onal Technology Park

From: plantenquiryservice@gtc-uk.co.uk <plantenquiryservice@gtc-uk.co.uk>

Sent: 18 June 2019 14:15

To: angela.brown@t-d-s.com

Subject: GTC Plant Enquiry - Ref- 1015963

GTC Apparatus Not Found In Search Area

Our Plant Enquiry Service Ref: 1015963

Your Enquiry Ref: New Hey Quarry

Dear Angela,

Thank you for your enquiry concerning apparatus in the vicinity of your proposed work. GTC can confirm that we have no apparatus in the vicinity but please note that other asset owners may have and ensure all utility owners have been consulted. For your records, the search area is shown in the attached map.

Please note our assets now include those owned and operated by:

- GTC Pipelines Limited
- Independent Pipelines Limited
- Quadrant Pipelines Limited
- Electricity Network Company Limited
- Independent Power Networks Limited
- Independent Water Networks Limited
- Independent Fibre Networks Limited
- Independent Community Heating Limited

If you have any queries or require any further information please do not hesitate to contact us.

Your sincerely,

GTC Plant Enquiry Service.

GTC
Energy House
Woolpit Business Park
Woolpit
Bury St Edmunds
Suffolk, IP30 9UP
Tel: 01359 240363
plant.enquiries@gtc-uk.co.uk

NOTE:

This E-Mail originates from GTC, Energy House, Woolpit Business Park, Woolpit, Bury St Edmunds, Suffolk, IP30 9UP
VAT Number: GB688 8971 40. Registered No: 029431.

DISCLAIMER

The information in this E-Mail and in any attachments is confidential and may be privileged. If you are not the intended recipient, please destroy this message, delete any copies held on your system and notify the sender immediately. You should not retain, copy or use this E-Mail for any purpose, nor disclose all or any part of its content to any other person. Whilst we run antivirus software on Internet E-Mails, we are not liable for any loss or damage. The recipient is advised to run their own up to date antivirus software.

Thank you

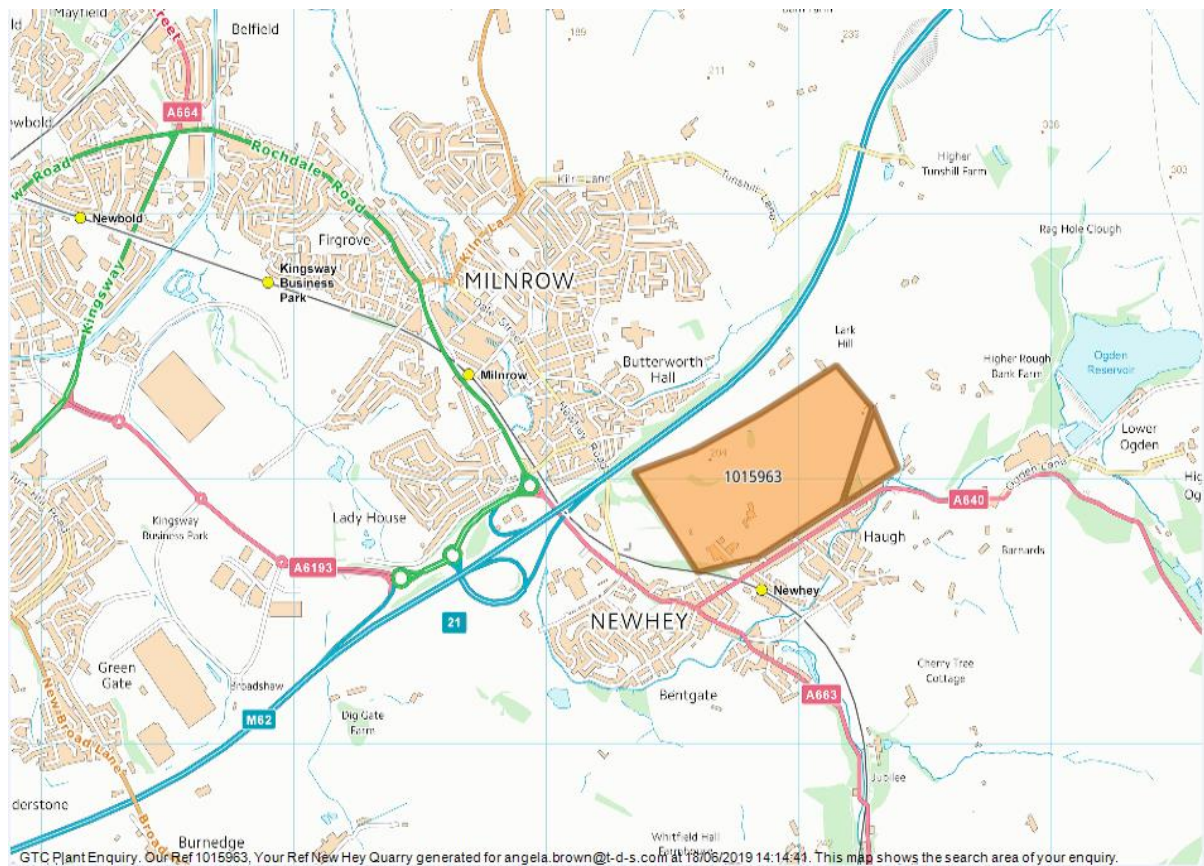

https://pe.gtc-uk.co.uk/Plant_Enquir - Plant Enquiries

Enquiry Result

Enquiry Reference:1015963

No GTC plant has been found in the area selected, a confirmation email has been sent to your registered email address

Notes:

- There maybe a delay of up to 30 minutes before you receive the email response.

Create Polygon
Modify Polygon
Submit Enquiry
[Need help getting started?](#)

14:10
18/06/2019

From: Plantenquiries <Plantenquiries@instalcom.co.uk>

Sent: 25 June 2019 12:05

To: 'Angela Brown' <angela.brown@t-d-s.com>

Subject: RE: E06-19-4907 Linesearch - Proposed Development - New Hey Quarry, Rochdale.

Dear Sir or Madam,

Thank you for your plant enquiry below.

We can confirm that CenturyLink Communications UK Limited (formerly Level 3), Global Crossing (Uk) Ltd, Global Crossing PEC, Fibernet UK Ltd and Fibrespan Ltd do not have any apparatus within the indicated works area.

Instalcom responds to plant enquiries for all of the above and therefore you only need send one plant enquiry to cover all of these companies.

Please note that this response is only valid for 3 months. If your works do not commence within this time period, please resubmit your plant enquiry for assessment before any works commence.

Regards

Plant Enquiries Administrator



Instalcom Limited
Borehamwood Ind Park
Rowley Lane
Borehamwood
WD6 5PZ

Office: +44 (0)208 731 4779

Fax: +44 (0)208 731 4601

Email: plantenquiries@instalcom.co.uk

Web: <http://www.instalcom.co.uk>



From: KPN Plant Enquiries <kpn.plantenquiries@instalcom.co.uk>

Sent: 24 June 2019 12:40

To: 'Angela Brown' <angela.brown@t-d-s.com>

Subject: RE:K06-19- 2394 Linesearch - Proposed Development - New Hey Quarry, Rochdale.



Dear Sir or Madam,

With reference to your plant enquiry below, we can confirm that KPN do not have any apparatus within the immediate proximity of your proposed works.

If you require any further information, please do not hesitate to contact us.

Please note that this response is only valid for 3 months. If your works do not commence within this time period, please resubmit your plant enquiry for assessment before any works commence.

Regards

Plant Enquiries Dept
Instalcom Limited
Borehamwood Ind. Park
Rowley Lane
Borehamwood
WD6 5PZ

Office: +44 (0)208 731 4613

Fax: +44 (0)208 731 4601

Email: kpn.plantenquiries@instalcom.co.uk

Web: <http://www.instalcom.co.uk>



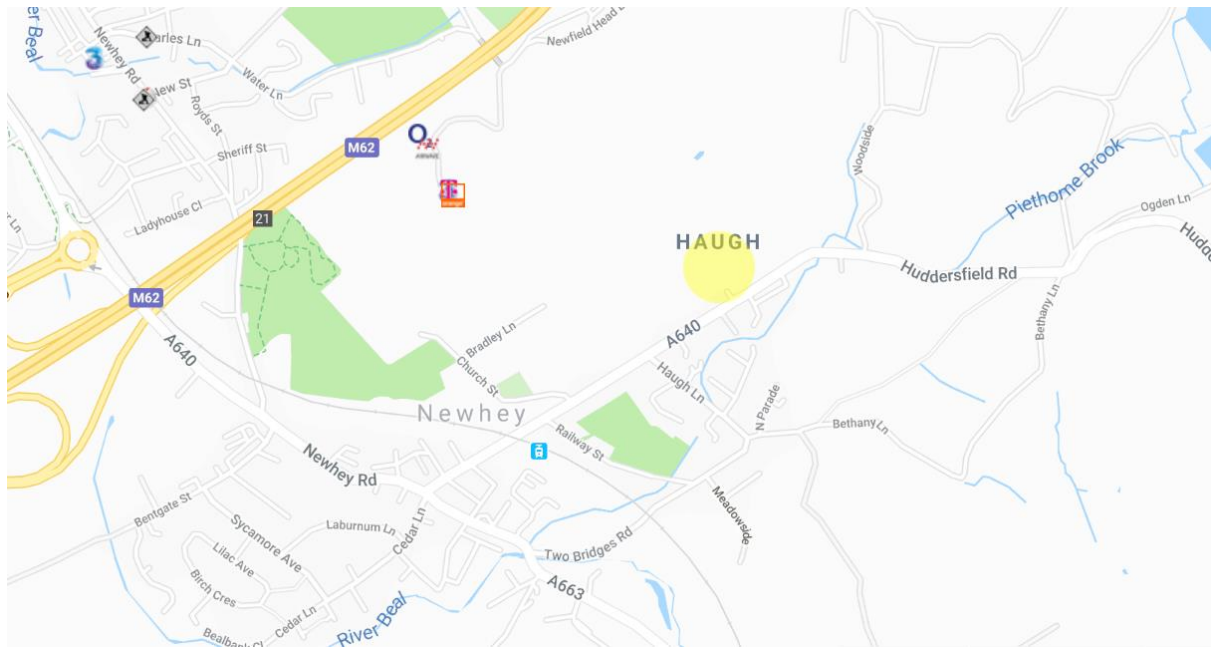

Mobile Masts in vicinity of site.

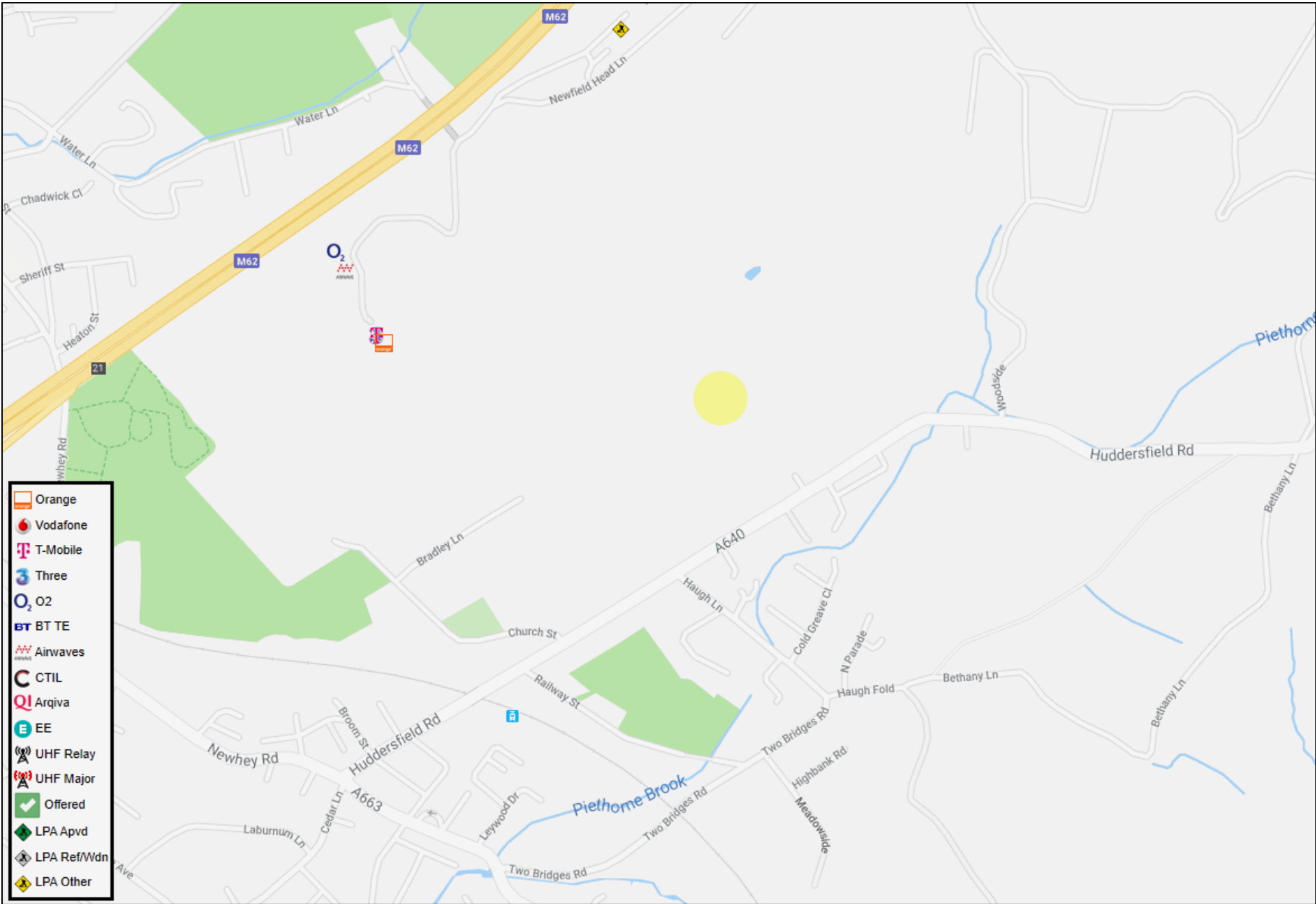

From: Adams Mandy <Mandy.Adams@networkrail.co.uk> **On Behalf Of** OP Buried Services Enquiries
Sent: 18 June 2019 11:28
To: Angela Brown <angela.brown@t-d-s.com>
Subject: RE: Linesearch - Proposed Development - New Hey Quarry, Rochdale.

With regards to your enquiry, Network Rail does not believe there is any Network Rail owned apparatus or underground services within the area you have defined. As there is always the possibility that new works could be planned and undertaken in this area by Network Rail this information is valid as at today's date and is supplied for general guidance only.

Please be aware that this response is based on Network Rail's records and knowledge and no guarantee can be given regarding accuracy or completeness. CAT scans, safe digging practices (as contained in HSE publications) and other appropriate investigative techniques should always be carried out.

There may be other apparatus or underground services owned or operated by Utility Companies and accordingly you should contact individual utilities for information.

If, in connection with your investigations and/or work, you become aware of Network Rail apparatus or underground services within your area of work, please ensure these are notified to our Asset Protection team via the following link as a matter of urgency so that appropriate measures for avoidance of risk and damage can be put in place.

<http://www.networkrail.co.uk/asp/1758.aspx?cd=1>

If you require any further clarification on any of the information please contact opburiedservicesenquiries@networkrail.co.uk.

Regards

Mandy Adams

Distribution Administrator, Worksite Survey

Asset Information Services: inspiring & enabling through the power of data

National Records Centre, Audax Road, Clifton Moor, York, YO30 4US

T: 01904 386374 (int: 35374)

E: mandy.adams@networkrail.co.uk

Network Rail – working for you

AIS Hub

[Visit the new AIS Hub site](#) for information, user guides, key contacts, and more on all our services. AIS Hub is replacing ASD Online and our Connect pages from Monday 3 September 2018

Worksite Survey Page [Visit the Worksite Survey Hub Site](#)

For information on the services we offer and search request forms

From: Liddle, Peter <Peter.Liddle@northernpowergrid.com>
Sent: 02 July 2019 09:00
To: Angela Brown (angela.brown@t-d-s.com) <angela.brown@t-d-s.com>
Subject: Sensitive:New Hey Quarry

Hi re the above This not within NPG Area.

Peter Liddle

This message classified as **NPg-Sensitive** on **02 July 2019 09:00:09**

E mail Disclaimer

You agree that you have read and understood this disclaimer and you agree to be bound by its terms.

The information contained in this e-mail and any files transmitted with it (if any) are confidential and intended for the addressee only. If you have received this e-mail in error please notify the originator.

This e-mail and any attachments have been scanned for certain viruses prior to sending but neither Northern Powergrid Holdings Company nor any of its associated companies from whom this e-mail originates shall be liable for any losses as a result of any viruses being passed on.

No warranty of any kind is given in respect of any information contained in this e-mail and you should be aware that it might be incomplete, out of date or incorrect. It is therefore essential that you verify all such information with us before placing any reliance upon it.

Northern Powergrid Holdings Company

Lloyds Court

78 Grey Street

Newcastle upon Tyne

NE1 6AF

Registered in England and Wales: Number 3476201

From: NRSWA <nrswa.nrswa@sky.uk>

Sent: 18 June 2019 11:16

To: angela.brown@t-d-s.com

Subject: Linesearch - Proposed Development - New Hey Quarry, Rochdale.



Thank you for your enquiry.

Please be advised that Sky Telecommunications Services Ltd will not be affected by your proposal.

Best endeavours have been made to ensure accuracy, however if you require further information, please contact us by email at nrswa@sky.uk.

Regards

NRSWA Department

Tech UK - Implementation

sky | TECHNOLOGY

✉ nrswa@sky.uk ☎ +44 20703232234

From: SOTA Plant Enquiries <SOTA.PlantEnquiries@instalcom.co.uk>

Sent: 21 June 2019 11:39

To: 'Angela Brown' <angela.brown@t-d-s.com>

Subject: RE:S06-19- 1351 Linesearch - Proposed Development - New Hey Quarry, Rochdale.



Dear Sir or Madam,

With reference to your plant enquiry below, we can confirm that SOTA do not have any apparatus within the immediate proximity of your proposed works.

If you require any further information, please do not hesitate to contact us.

Please note that this response is only valid for 3 months. If your works do not commence within this time period, please resubmit your plant enquiry for assessment before any works commence.

Regards

Plant Enquiries Dept.
Instalcom Limited
Borehamwood Ind. Park
Rowley Lane
Borehamwood
WD6 5PZ

Office: +44 (0)208 731 4613

Fax: +44 (0)208 731 4601

Email: sota.plantenquiries@instalcom.co.uk

Web: <http://www.instalcom.co.uk>



From: MBNLplantenquiries <mbnl.plant.enquiries@turntown.com>

Sent: 21 June 2019 14:33

To: Angela Brown <angela.brown@t-d-s.com>

Subject: RE: Linesearch - Proposed Development - New Hey Quarry, Rochdale.

Dear Sir/Madam

Turner & Townsend Project Management are appointed on behalf of MBNL to conduct Plant (apparatus) Searches *in accordance with the relevant NRSWA Act 1991- Diversionary Works legislation*. These searches considered plant belonging to EE (T-Mobile and Orange sites) and the H3 mobile telecommunication networks.

Further to your plant enquiry please see the response below to the NRSWA request submitted

MBNL do not have any plant that would be affected by the proposed work. Should you have any further queries please use the contact details below.

PS: Please can you send all future Plant enquiries for EE or H3G to this email address mbnlplantenquiries@turntown.com

Kind Regards

Zahra Ahmed
Junior Consultant

Turner & Townsend Advisory

t: 0121 262 3663 | m: 07811 833434 | www.turnerandtowntsend.com

Turner & Townsend Europe Limited

Registered office: Low Hall, Calverley Lane, Horsforth, Leeds LS18 4GH, United Kingdom |

Registered in England and Wales | Registration No: 3514794

-----Original Message-----

From: assetrecords@utilityassets.co.uk <assetrecords@utilityassets.co.uk>

Sent: 18 June 2019 11:11

To: angela.brown@t-d-s.com

Subject: Re: Linesearch - Proposed Development - New Hey Quarry, Rochdale.

Thank you for recently contacting Utility Assets plant record department. We will check whether we have any plant present at your site and contact you within 5 - 7 working days ONLY if we own any plant in the vicinity.

If we do not reply, we do not have any apparatus in the area of your works. However, PLEASE TAKE CARE when excavating around electricity cables in the event that not all cables present may be accurately shown. We recommend you use detecting equipment to map the site before excavating and fully comply with HSG47. DO NOT assume that a cable is dead if you don't have a record of its presence. The cable must be treated as live unless PROVEN DEAD by the cable owner. In case of emergency please contact your local electricity distribution company.

This is an automated reply from our dedicated asset records email address. If you receive further correspondence from us it will be from asset.manager@utilityassets.co.uk quoting a site reference number.

Asset Manager - Utility Assets Ltd

From: UK OSP-Team <osp-team@uk.verizon.com>

Sent: 18 June 2019 15:36

To: Angela Brown <angela.brown@t-d-s.com>

Cc: UK OSP-Team <osp-team@uk.verizon.com>

Subject: RE: [E] Linesearch - Proposed Development - New Hey Quarry, Rochdale.

Dear Sir/Madam

Verizon is a licensed Statutory Undertaker.

We have reviewed your plans and have determined that Verizon (Formally known as MCI WorldCom, MFS) has no apparatus in the areas concerned.

If you have any further queries please do not hesitate to get in touch.

Yours faithfully

Plant Protection Officer E.mail osp-team@uk.verizon.com



From: Ramanikanthan, Jayakanth <Jayakanth.Ramanikanthan@atkinsglobal.com>

Sent: 25 June 2019 12:42

To: caroline.gavin@t-d-s.com

Subject: RE: Proposed Development - New Hey Quarry, Rochdale

Please accept this email as confirmation that Vodafone: Fixed **does not** have apparatus within the vicinity of your proposed works detailed below.

Many thanks

Plant Enquiries Team

T: +44 (0)1454 662881

E: osm.enquiries@atkinsglobal.com

This response is made only in respect to electronic communications apparatus forming part of the Vodafone Limited electronic communications network formerly being part of the electronic communications networks of Cable & Wireless UK (now re-named Vodafone Enterprise UK), Energis Communications Limited, Thus Group Holdings Limited and Your Communications Limited.

ATKINS working on behalf of Vodafone: Fixed



PLEASE NOTE:

The information given is indicative only. No warranty is made as to its accuracy. This information must not be solely relied upon in the event of excavation or other works carried out in the vicinity of Vodafone plant. No liability of any kind whatsoever is accepted by Vodafone, its servants, or agents, for any error or omission in respect of information contained on this information. The actual position of underground services must be verified and established on site before any mechanical plant is used. Authorities and contractors will be held liable for the full cost of repairs to Vodafone's apparatus and all claims made against them by Third parties as a result of any interference or damage.



Please consider the environment before printing this e-mail

APPENDIX 2 – Assumed Diversions

From: mark.6.anderson@openreach.co.uk <mark.6.anderson@openreach.co.uk>

Sent: 01 August 2019 08:54

To: angela.brown@t-d-s.com

Subject: FW: * Colette 15.07 * Diversion query re BT Openreach - Proposed Development - New Hey Quarry, Rochdale

Importance: High

Hi Angela,

Based on the plan that was submitted to us (000-008-A3-A - Proposed Entrance to New Hey Quarry.pdf), I am not able to confirm if the poles in question will be affected by your development.

Please can you get me a more detailed plan for this area... showing the interface at the site boundary and the rear of the existing properties.

Regards,

Mark Anderson

Repayments Project Engineer

Openreach

Telephone: 01138074513

Mobile: 07802190381

Web: www.openreach.com

We build and maintain the digital network that enables more than 600 providers to deliver broadband to homes, hospitals, schools and businesses large and small. Our engineers work in every community, every day, because we believe everyone deserves decent and reliable broadband.

This email contains Openreach information, which may be privileged or confidential. It's meant only for the individual(s) or entity named above. If you're not the intended recipient, note that disclosing, copying, distributing or using this information is prohibited. If you've received this email in error, please let me know immediately on the email address above. We monitor our email system and may record your emails.

Openreach Limited

Registered Office: Kelvin House, 123 Judd Street, London WC1H 9NP

Registered in England and Wales no. 10690039

From: Angela Brown [<mailto:angela.brown@t-d-s.com>]

Sent: 26 July 2019 11:58

To: Anderson,M,Mark,BQRA31 R

Subject: RE: * Colette 15.07 * Diversion query re BT Openreach - Proposed Development - New Hey Quarry, Rochdale

Importance: High

Hi Mark,

Thanks for the response.

Can I just double check with you though please as there appear to be overhead poles that run to the right of Bradely Street that will be running along the proposed site boundary. Will these not be affected? Please can you confirm.?

Thanks.

Regards.

Angela.

From: mark.6.anderson@openreach.co.uk <mark.6.anderson@openreach.co.uk>

Sent: 22 July 2019 08:38

To: angela.brown@t-d-s.com

Subject: RE: * Colette 15.07 * Diversion query re BT Openreach - Proposed Development - New Hey Quarry, Rochdale

Hi Angela,

Please find attached response.

We have no apparatus recorded at this location.

Any issues come back to me.

Regards,

Mark Anderson

Repayments Project Engineer

Openreach

Telephone: 01138074513

Mobile: 07802190381

Web: www.openreach.com

We build and maintain the digital network that enables more than 600 providers to deliver broadband to homes, hospitals, schools and businesses large and small. Our engineers work in every community, every day, because we believe everyone deserves decent and reliable broadband.

This email contains Openreach information, which may be privileged or confidential. It's meant only for the individual(s) or entity named above. If you're not the intended recipient, note that disclosing, copying, distributing or using this information is prohibited. If you've received this email in error, please let me know immediately on the email address above. We monitor our email system and may record your emails.

Openreach Limited

Registered Office: Kelvin House, 123 Judd Street, London WC1H 9NP

Registered in England and Wales no. 10690039

APPENDIX 3 – Points of Connection

Ms Angela Brown
Technical & Development Services (Northe
Northern House
3A Kennerleys Lane
Wilmslow
SK9 5EQ

Electricity North West
Frederick Road
Salford
M6 6QH
Web: www.enwl.co.uk

Our Ref: 5500153161/A

T: 0800-195-4141
DD: 08433114374
E: darren.mycock@enwl.co.uk

10 July 2019

Dear Ms Angela Brown

Re: IDNO Point of Connection for Former New Hey Quarry, Rochdale, OL16 3QG

Thank you for your recent enquiry requesting a quotation in relation to the above.

Our price for carrying out the statutory works, detailed in the project specification, is £18,013.29 plus VAT of £3,602.66 totalling £21,615.95.

The quotation is valid for a period of 180 days from the date of this letter. A detailed price breakdown can be found on the following pages.

The works and the assumptions made in calculating our price are based on your application and are detailed in the Project Specification. Please take time to read through and check these details and should you wish to make any amendments please notify us at the earliest opportunity.

The offer is subject to Electricity North West General Conditions of Contract and the Project Specification. A full copy of the Electricity North West Limited General Conditions of Contract (business) can be viewed at <http://www.enwl.co.uk/our-services/connection-services/help-faqs/terms-and-conditions>. If you are unable to access the internet please contact us on 0800 048 1820 and we will post a copy to you.

There is a new Competition in Connections Code of Practice that came into effect on the 30th October 2015. This party enables third party connectors to undertake more activities associated with a new connection. Further details can be found on our website.

To enable you to comply with the Construction (Design and Management) Regulations 2015, a full method statement will be provided to you once we acknowledge receipt of your signed Customer Acceptance Form. The statement will reflect the generic and site-specific risks and the working methods adopted by our appointed contractor for works undertaken on behalf of Electricity North West.

If you wish to proceed, please return the following by email to cic@enwl.co.uk or by post to the address above

- Completed Customer Acceptance Form.
- Payment for the full amount of the price stated including VAT at the appropriate rate by cheque payable to Electricity North West Limited or BACS / CHAPS transfer.
- Design Approval pack from a NERS accredited company.

We would like to thank you for your valued enquiry and look forward to working closely with you in due course. If you require any further assistance please do not hesitate to contact me.

Yours sincerely,

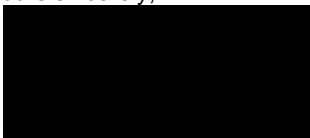

Darren Mycock
Electricity North West

Description of the works**The charges included are for POC charges:**

- Only nominal costs for legal consents have been included
- HV shutdown to commission substation.
- For additional bespoke information, please refer to the project specification.
- Assessment and Design

The charges do not include for:

- Land acquisition costs for legal consents etc
- Electricity North West HV &/or LV network energisation connection.
- Damage to crops / land during operational access / work etc.
- Unidentified HV &/or LV infrastructure diversion works.
- Out of hours working.
- For additional bespoke information, please refer to the project specification.

Quotation price

The quotation price is provided based upon your application and the information you provided. The quotation only contains the non contestable charges associated with the new connection, this may include any contestable diversion and reinforcement costs.

Non Contestable Charges

If you require a full description of the non contestable charges these can be viewed on our website <http://www.enwl.co.uk/our-services/connection-services/help-faqs/useful-information/common-charging-methodology>. If you are unable to access the internet please contact us on 0800 048 1820 and we will post a copy to you.

Determinations

We hope you are satisfied with the service Electricity North West has provided and hope that any possible disputes have been resolved satisfactorily. However if a situation should arise and we are unable to reach a mutually acceptable solution, you can contact The Energy Ombudsman, who will assist in resolving the dispute. You can contact The Energy Ombudsman in writing to PO BOX 966, Warrington, WA4 9DF, by telephone on 0845 055 0760 or online at www.energy-ombudsman.org.uk

BREAKDOWN OF CHARGES

| Non Contestable Charges | | |
|--|-----------------|-------------------|
| Connection Charges | Quantity | Charge |
| Assessment Charges | 1 | £4,230.00 |
| Design Charges | 1 | £870.00 |
| Operational Work | 1 | £1,656.00 |
| Legal - Ind/com Way/easement developer/3rd party | 1 | £1,090.00 |
| | | |
| Connections – Construction Work | | |
| Sundry Equipment | 1 | £9,520.00 |
| Labels & Nameplates | 1 | £647.29 |
| Total Non Contestable Charge | | £18,013.29 |
| | | |
| Total Charge | | £18,013.29 |

CUSTOMER ACCEPTANCE FORM

Customer: Technical & Development Services (Northe

Our Reference: 5500153161/A

Project title: IDNO Point of Connection for Former New Hey Quarry

Site address: Rochdale, OL16 3QG

I accept your offer, dated 10 July 2019 for the works referenced above and any subsequent charges, as detailed in the project specification.

I agree to pay £18,013.29 plus VAT of £3,602.66 totalling £21,615.95 and payment for the full amount.

I acknowledge and agree that the works are subject to the Electricity North West General Conditions of Contract, a copy of which I have read.

I acknowledge that I must appoint an electricity supplier to the site before the connection/s can be made live.

The site will be ready for Electricity North West to commence works on _____ **(please enter date)**.

However I have read and understand clause 7 of the Electricity North West General Conditions of Contract, in relation to commencement of the works.

| | |
|---|--|
| Signature of customer or authorised signatory on behalf of customer: | |
| Date: | |
| SITE CONTACT DETAILS | |
| Contact Telephone Number: | |
| END USER DETAILS* | |
| Company/Customer Name: | |
| Customer Contact: | |
| Customer Telephone: | |
| Full Postal Address: | |
| Contact Name & Address (if different to site address): | |

* If there are multiple End Users, please provide additional details.

| |
|--|
| WAYLEAVE DETAILS (if different from End User)** |
|--|

| | |
|---------------------------------------|--|
| Name and Address of Landowner: | |
| Landowner Telephone: | |

** If there are multiple Landowners, please provide additional details.

Acceptance must include payment by cheque, made payable to Electricity North West Limited or by BACS/CHAPS in accordance with the guidance available on our website via the following ['link'](#)

If you are going to self approve your scheme design in line with the [Competition in Connections Code of Practice](#) please tick here (). The ENWL's user guide can be located on our [website](#)

POC PROJECT SPECIFICATION

Connections

A system study has now been carried out based on the information you provided:

Total load requirement of your connection is 1,707 kVA and consists of:

Upon acceptance we will provide you with additional network data to facilitate an earthing study necessary for your design submission. You are advised to return your acceptance as soon as possible to ensure this data can be provided in a timely manner to meet your project timescales

The POC offer includes the cost of Automation on the proposed substation due to the customer numbers.

On acceptance there is a requirement for a full harmonic study by you to ensure EV charging is within G5-4 limits.

HV Point of Connection 1

A Point of Connection has been identified on the High Voltage Network with a new substation to be looped in to an existing 6600V, 3c .25 cable using 3 x 1c300 SAC XLPE cable as shown on enclosed plan. The new substation to be located in a mutually agreed position.

Our quotation excludes all works from the point of connection to your interface.

This Point of Connection is valid for 180 days from the date of this quotation.

Offer Conditions

Application for a Point of Connection

- 1) The Point of Connection (POC) will be determined on the basis of the information on your application form and will not be guaranteed if any undeclared characteristics of the proposed load are found to cause electrical disturbances to the electricity network greater than those inferred on the original application form.
- 2) The IDNO is responsible for providing true and accurate load information to Electricity North West Limited.
- 3) All Connections for Embedded Distribution Networks shall comply with Electricity North West Limited ES 225.
 - Assessment & Design charges
 - Inspection Charges
 - Initial Energisation Cost*
 - Associated Diversion Work
 - Associated Reinforcement Work
 - Operation & maintenance charges (only if over and above the minimum cost scheme)
 - Costs for obtaining legal consents for the development

* The Initial Energisation Cost is for energisation of the installation at the POC only and will only be included in the offer if the network connection/s is a non-contestable joint/s or termination/s. It does not include for any on site non-contestable jointing work that may be requested following the initial energisation or for the energisation of any low voltage network if the POC was provided at high voltage.

- 2) The above charges become contractual on acceptance of the point of connection and will be included in the Electricity North West Limited 'Agreement to Adopt' contract which will be issued following design approval.
- 3) In certain circumstances diversion and reinforcement works are open to competition and are therefore classed as contestable (See Page 71, Section 6.12, Methodology and Charges for Connections Statement). If appropriate and if requested, a breakdown of the non-contestable elements for diversion and reinforcement costs may be supplied.

- 4) Indicative costs are given in Electricity North West Limited 'Statement of Methodology and Charges for Connection to the Electricity Distribution Network' which can be found on Electricity North West Limited web site: www.enwl.co.uk

Operational / Legal Consents

- 1) The Independent Connection Provider(ICP)/developer is legally responsible for and must make their own arrangements to obtain any legal consents to install or lay any electric line or cable on land owned by a third party. e.g. on privately owned land outside the development site. Electricity North West Limited will only obtain legal consents in so far as they are necessary or desirable for the operation of Electricity North West Limited network after asset adoption.

This will include any legal consents which the developer is required to grant for electric lines or cables within the development site which will be adopted by Electricity North West Limited. No electric lines or cables shall be installed in land not owned by the developer before agreement is reached with the landowner. This POC is, therefore, dependant on the ICP/developer being able to reach agreement with any third party landowner for any electric lines or cables, or any part thereof, which will be installed at or from the POC.

Please note that the date of energisation for the installation will not be arranged until all operational/legal consents have been completed with Electricity North West Limited.

- 2) Operational/Legal Consents include:

- Any easement, wayleave or licence required for any electric line or cable laid from the POC in private land which does not or will not form part of the public highway.
- Any lease or freehold transfer of land required for substations.
- Any Planning or statutory consent required in respect of any of the above.

- 3) The ICP/developer will be responsible for the cost of reinstating any damage to land not within the development site and for any for any costs associated with the acquisition of Operational/Legal Consents.

Health and Safety

- 1) The following information is given to assist you in maintaining safe working practices on the site:

Electricity North West Limited plans carry an endorsement stamp that is there for your safety. Before any machines are used, all of Electricity North West Limited underground assets should be located by manual excavation. All excavation should be done by taking the appropriate safety precautions in the 'Health and Safety Executive Guidance Note G47' 'Avoiding Danger from Underground Services'; taking cognisance of the fact that other plant may be in the vicinity which is not shown on the plans. Please ensure that the current issue of plans is referred to before commencing work on site.

Acceptance of Point of Connection

- 1) If you wish to accept the Point of Connection, a completed 'Acceptance' form with payment in full must be returned before the validity date expires. If your acceptance is not received before the expiry date then the available capacity on our network could be made available to subsequent applicants.
- 2) Your design submission must be submitted within 30 days of acceptance of the POC and must include the Design Submission Check List form. If your design is not received within the time stated then your acceptance will lapse and the point of connection could be allocated to another applicant without notice. Under exceptional circumstances you may apply in writing for a further 30 days extension. You will also be liable for any abortive costs incurred in failure to comply with the above.
- 3) These forms are an integral part of the design submission and the process of design approval will not start until they have been received. Any errors on the forms will also delay the start of the process.

- 4) Following design approval, Electricity North West Limited will issue the ICP with an 'Agreement to Adopt' contract. The ICP will then be responsible for obtaining all required signatures on the 'Agreement to Adopt'. Electricity North West Limited will not undertake any activities associated with the electricity connection works until this Agreement has been signed, this includes any audits of the work intended to be adopted. It should be noted that Electricity North West Limited will not adopt any new connections work that we have not had an opportunity to audit until we are satisfied that the installation meets Electricity North West Limited standards.

Generation

- 1) Unless it is included within your application, you must contact Electricity North West Limited if you intend to provide facilities to allow the export of electricity (including by means of CHP, solar cells, wind turbines etc) into the electricity distribution network or operate on site generation that interconnect with our supplies, including as a means of an emergency supply. We reserve the right to amend our price and programme of works in association with these facilities.

Non-Linear Loads (motors, welders and rectifiers)

- 1) Motors, Welders, and other equipment likely to affect the supplies to other consumers must not be connected without prior approval from Electricity North West Limited.
- 2) For all non-linear loads, it is your responsibility to ensure that the cumulative effect of any harmonic-generating equipment (e.g. Rectifiers, invertors & variable speed motor drives) complies with Industry Standards. If complaints are received from other customers connected to the Distribution System regarding supply disturbance and these can be directly attributed to your equipment, then Electricity North West Limited reserve the right to insist that you disconnect the offending equipment remedial action is taken by yourself, at your expense.

Disconnection

- 1) We have not included the costs for any existing service disconnection/s in our quotation. For all disconnections please contact Electricity North West Customer Service on 0800 048 1820.

For Planning Purpose Only

PROJECT DETAIL

Title: Former New Hey Quarry

Address: , Rochdale, OL16 3QG

Scheme Ref Number: 5500153161/A

Drawn By: Darren Mycock

Date: 10-Jul-2019

Grid Reference: (X) 393813
(Y) 411648

Scale: N.T.S

Point of Connection Expiry Date:
Valid for a period of 180 days from the date of the Quotation

POINT OF CONNECTION
TECHNICAL DETAIL

Cable Size @ P.O.C : 3c.25 6.6
Voltage : 6600 Volts
Minimum Cable Size : 3x1c 300 SAC XLPE
Loop or Teed (HV only) Looped
Primary - Feeder Name : Milnrow Primary - Albert Mill
Transformer Size : kVA
Fuse Size : Amps
Earth Loop Impedance : ohms
% Voltage Drop
1) Including site load %
2) excluding site Load %

Generation:
Voltage Rise relative to primary BB : %
Positive sequence R+JX (% on 100MVA base)

Notes :

For reference only

Point Of Connection

Connect to 3c .25 Cu between Gordon St (329012) & Railway St (314732) Distribution Substations

Substation / PMT Earthing

Customer / Electricity North West to carry out an earthing study to ensure the safe management of Earth Potential Rise (EPR) and the establishment of safe touch, step and transfer potentials. Facilitating data to be provided by Electricity North West upon acceptance.

DANGER OF DEATH

ALL EXCAVATION TO COMPLY WITH THE HEALTH & SAFETY EXECUTIVE GUIDE (HSG47) "AVOIDING DANGER FROM UNDERGROUND SERVICES" AND (HSG6), "AVOIDING DANGER FROM OVERHEAD POWER LINES". AT ALL TIMES TAKING INTO ACCOUNT THAT OTHER PLANT MAY BE IN THE VICINITY WHICH IS NOT SHOWN ON OUR PLANS.

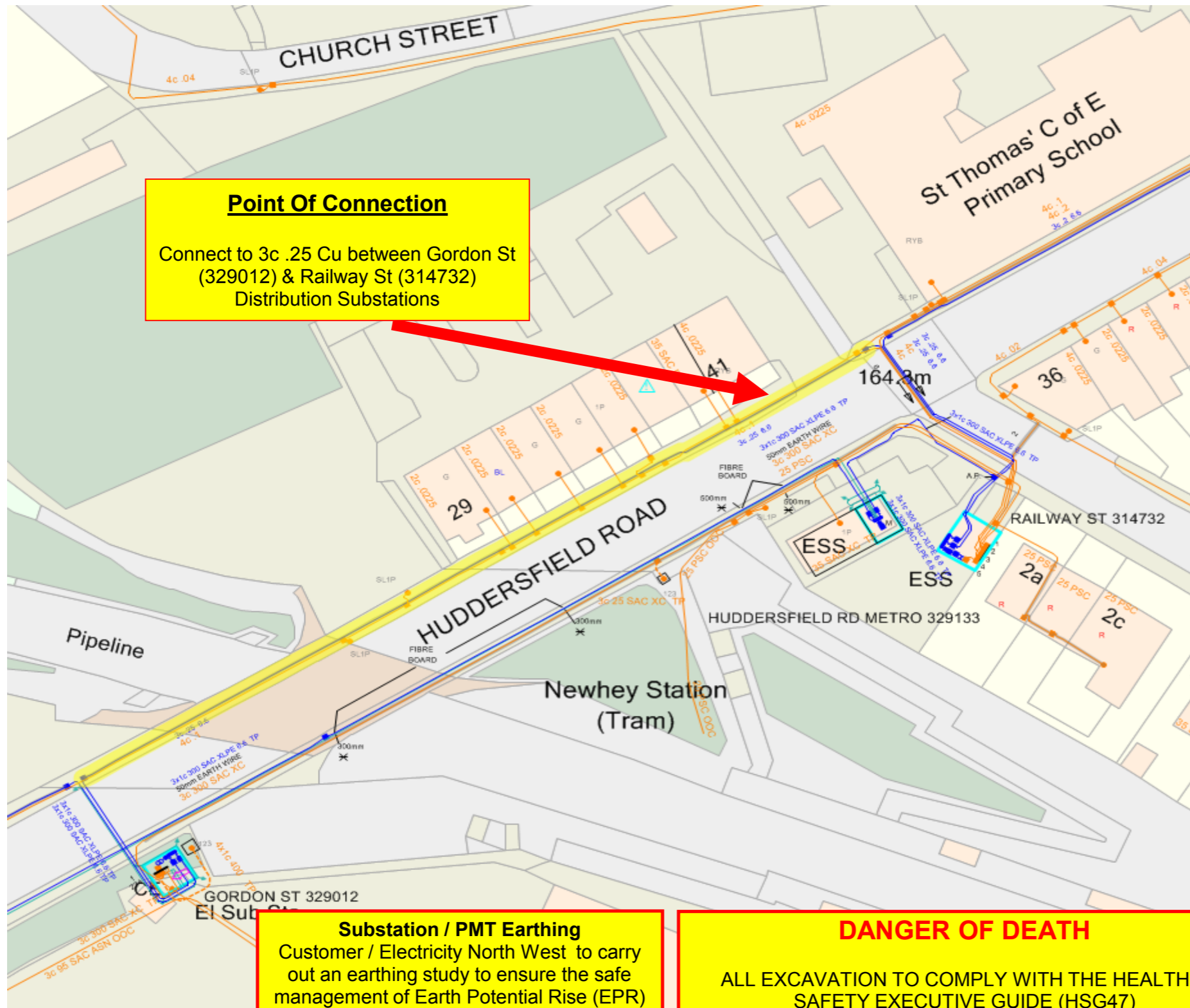

N

This plan is issued by Electricity North West Limited. Unless otherwise indicated Electricity North West Limited cables are laid at depths in accordance with NJUG 2 (typically 450mm for Low Voltage & 600mm for 11KV cables in footpath). 33KV/132KV cables are laid at depths as marked. The depths and positions of Electricity North West Limited equipment was accurate as shown when the equipment was installed. However, third parties may have altered the surface level & other reference data. Therefore Electricity North West Limited accept no responsibility for the position of Electricity North West Limited equipment being different from that shown. No person, body or company, shall be relieved from liability for damage caused to Electricity North West Limited equipment by reason of being located differently to the indications on this drawing. Service cables are not necessarily shown but must be assumed to exist to all premises, streetlights and signs. There may be other Electricity North West Limited apparatus in the vicinity which is not indicated in the cable records.

Other apparatus may also be present which is owned by a third party other than Electricity North West Limited. Reproduced from or based upon Ordnance Survey's map with permission of the controller of Her Majesty's Stationery Office. Crown Copyright Reserved. LICENCE No 100017892. Unauthorised reproduction infringes Crown Copyright and may lead to prosecution or civil proceedings. Reference should be made to HSE guidance HS(G)47 "Avoiding Danger from Underground Services" and GS6 "Avoidance of Danger from Overhead Power Lines". Electricity North West Limited, registered number 2366949, registered in England and Wales, registered office: 304 Bridgewater Place, Birchwood Park, Warrington, WA3 6XG

Network Enquiry No : 180011354
Your Reference : OL16 3QF

Cadent Gas Limited

National Gas Emergency Service - 0800 111 999* (24hrs)
*calls will be recorded and may be monitored

Angela Brown
TDS Northern
3A KENNERLEYS LANE
WILMSLOW
SK9 5EQ

Date : 24th June 2019
Contact : Performance and Support
Direct Tel : 0845 3666758
Email : networkdesign@cadentgas.com

www.cadentgas.com

Dear Angela,

Re: Land Enquiry for Proposed Development Site at NEW SUPPLY, FORMER NEW HEY QUARRY, ROCHDALE, OL16 3QF.

Thank you for your enquiry which we received on 18th June 2019. I enclose details of Cadent Gas plant in the vicinity of your proposed supply.

The nearest main with sufficient capacity is 50 metres from the site boundary and it is a Low Pressure main.

This Developer Enquiry response is a reflection of the network at the time delivered and is not a guarantee of gas flow or capacity due to the changing dynamics of the gas distribution network. If you wish to secure capacity and connect to the network please submit quotation Connections Request via the official connections route allowing for further analysis to verify the capability of the network again.

Plans attached: Yes

A copy of the Cadent Connections Charging Statement referenced in this letter can be found on Cadent's website:

<http://cadentgas.com/Get-connected>

If you require a printed version please contact us on the details provided above.

I trust this meets with your requirements at this stage. If you have any queries please do not hesitate to contact Performance and Support on the above number.

Yours sincerely,

Claire Wilcox
Design Specialist



Cadent Gas Limited
Registered No.10080864
Registered Address Ashbrook Court, Prologis Park, Coventry, CV7 8PE

Letter Id: CRM013
Page 1 of 1

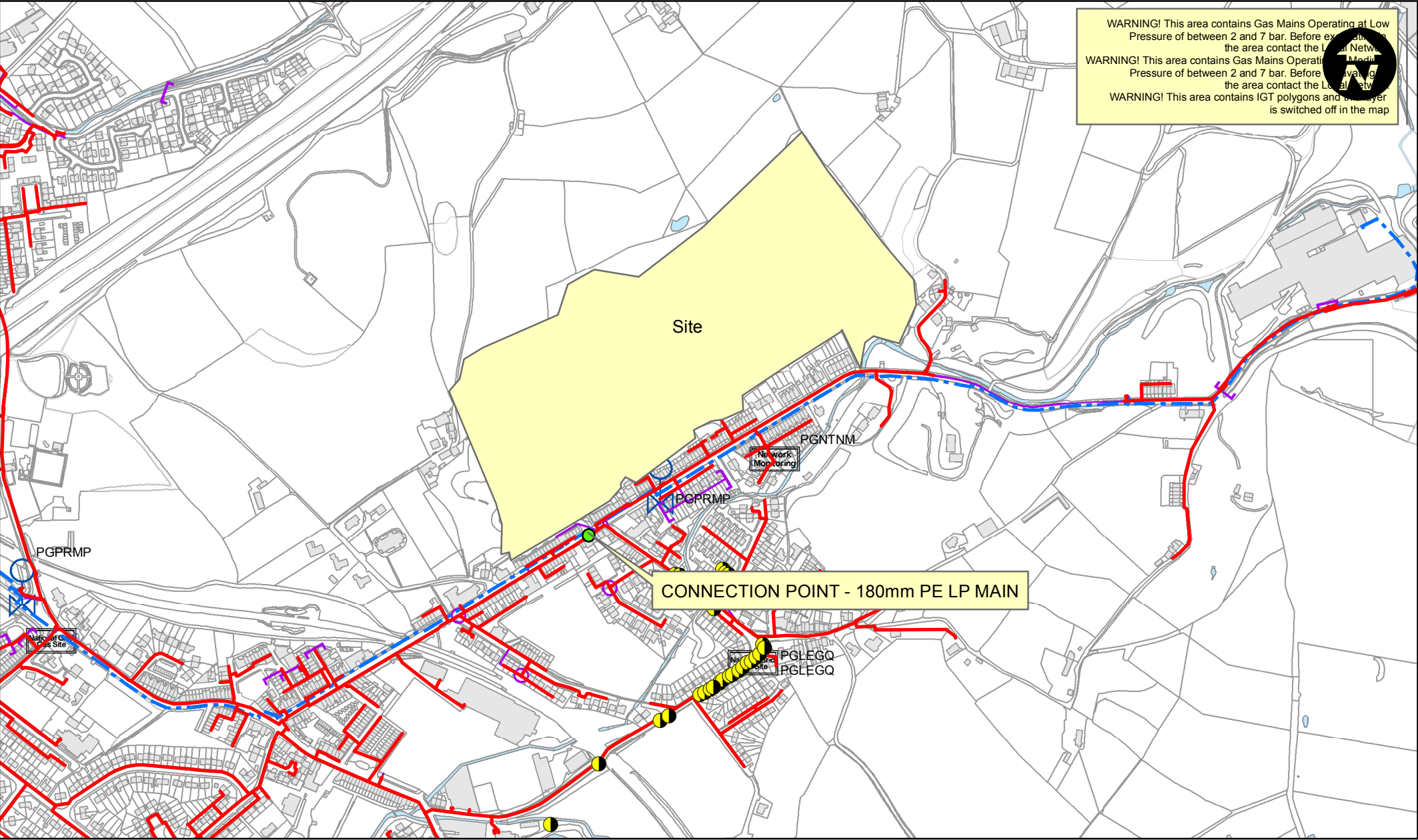

WARNING! This area contains Gas Mains Operating at Low Pressure of between 2 and 7 bar. Before excavating the area contact the Local Network Manager.

WARNING! This area contains Gas Mains Operating at Low Pressure of between 2 and 7 bar. Before excavating the area contact the Local Network Manager.

WARNING! This area contains IGT polygons and a layer is switched off in the map.

SCALE: 1:500 @ A4

USER ID: joanne.bebington

DATE: 24-Jun-2019 14:26:08

INTERNAL USE ONLY

OS Ref: 394150, 411899

CENTRE: <Centre>

L/P GAS MAIN
M/P GAS MAIN
I/P GAS MAIN
H/P GAS MAIN
N/H/P GAS MAIN
PROPOSED PIPE - LP
PROPOSED PIPE - MP
PROPOSED PIPE - IP
ABANDON - LP
ABANDON - MP
Out Of Standard Service



Some examples of Plant Items:

Valve Syphon Depth of Cover Change of Dia Change of Material

SCHEME: <NG GDO Scheme Name>
DESIGN: <NG GDO Design Number>
REVISION: <NG GDO Revision>

This plan shows those pipes owned by Cadent in its role as a Licensed Gas Transporter (GT). Gas pipes owned by other GTs, or otherwise privately owned, may be present in this area. Information with regard to such pipes should be obtained from the relevant owners. The information shown on this plan is given without warranty, the accuracy thereof cannot be guaranteed. Service pipes, valves, syphons, stub connections, etc., are not shown but their presence should be anticipated. No liability of any kind whatsoever is accepted by Cadent Gas Limited or their agents, servants or contractors for any error or omission. Safe digging practices, in accordance with HS(G)47, must be used to verify and establish the actual position of mains, pipes, services and any other apparatus on site before any mechanical plant is used. It is your responsibility to ensure that this information is provided to all persons (either direct labour or contractors) working for you on or near gas apparatus. The information included on this plan should not be referred to beyond a period of 28 days from the date of issue.

180011354



This plan is reproduced from or based on the OS map by Cadent Gas Limited, with the sanction of the controller of HM Stationary Office. Crown Copyright Reserved..

Your guidance for your Point of connection enquiry



Technical & Development Services (Northern)
3A Kennerleys Lane
Wilmslow
Cheshire
SK9 5EQ

United Utilities Water Limited
Developer Services Water
Water Connections
Second Floor Grasmere House
Lingley Mere Business Park
Lingley Green Avenue
Warrington WA5 3LP

Telephone: 0345 072 6067

Email: developerserviceswater@uuplc.co.uk

Our Ref: 4100394429

Date: 17/7/19

Dear Angela

Location: **Former New Hey Quarry, Huddersfield Road, Rochdale, OL16 3QG**

I have looked at your proposals and based on current information, to provide clean water for your development, we will need to install additional network capacity. It is possible that you will need to make a contribution toward the cost of this additional capacity.

The reinforcement and increased capacity required to feed your development is currently subject to an extensive modelling exercise, which will determine the most cost effective solution to providing a water supply within UU standards of service to your site.

Please provide us with a build program for the development to help us plan the reinforcement work.

Point of connection

The point of connection for the water supply to your development is along a section of the existing 18" CI water main, located on Haugh Fold, as shown on the attached drawing.

Existing United Utilities water assets

To help plan your development I have enclosed a copy of our asset records. This shows that we have no operational assets within the boundaries of your proposed development.

It is the responsibility of the developer to arrange for the disconnection of the existing services to site.

Note billing only accepts written requests to email: customer.services@uuplc.co.uk

You will need to attach the bill and the request to disconnect and confirm if the property was domestic or commercial.

Important note

This copy of our asset records is only provided to help you assess the likely risks when planning your development at a desk top stage. It is not intended to be used for planning any actual excavation or construction work. You are reminded that a Health and Safety plan should include an up to date record of all underground equipment.

Infrastructure Charges

Based on the information you have provided we would advise you to allow a budget of **£765.00 per plot** for water and wastewater infrastructure charges for the planned **400 new connections**. At present this charge is outside the scope of VAT.

Infrastructure Credits

We have no record of any water or sewerage connections to previous premises on this site within the last 5 years. This means that we are unable to offer any infrastructure credits against new connections on your proposed development.

What to do next:

If you decide to proceed with your development, you can choose between requisitioning your new clean water directly from us, or you can employ a contractor directly to self-lay the new mains. A list of approved installers is available at Lloyds Register www.lr.org. If your development will be using water for domestic purposes we will often provide an allowance in respect of future water use toward the cost of your new main, this allowance is the same no matter who you choose to lay your development main.

The information given is valid for up to 6 months, if you need any further information or assistance, please do not hesitate to contact me at this office.

Please do not hesitate to contact us should you need further assistance 0345 072 6067 or email to Developerserviceswater@uuplc.co.uk, always using our reference number provided on this letter.

Regards

Jenny Smith
Assistant Design Engineer

Enc. UU assets plan
 General Conditions and Precautions Leaflet

Water Industry Act Section 47(3) Counter Notice

Please note that in accordance with Section 47(3) of the Water Industry Act 1991, United Utilities Water requires compliance with the conditions below, prior to the connection of any service connection to any of United Utilities Water's mains that form part of your requisition application.

- Advance security may be required to be lodged with United Utilities Water equal to the total value of any connections and associated ancillary works. We will in due course estimate the cost of these works and provide you with the value of any security that may be required.
- Premises under separate occupation must be supplied by separate individual service pipes.
- Where it is deemed appropriate by United Utilities Water, a meter will be installed to determine the volumetric charge for the supply of water which can be connected by our contractor or by an approved third party in accordance with United Utilities Water's specification.
- Laying of the service pipe to a depth of no less than 750mm and no more than 1350mm below finished ground level, within the private land from the Street boundary into your premises. Service pipes must be installed to United Utilities Water's current specifications, and have a stopcock fitted. Standard connections (up to 25mm OD) shall consist of an un-jointed appropriate type and construction of pipe with marker tape laid no more than 400mm below finished ground level. Provision for volumetric metering must be installed fully in accordance with United Utilities Water's current specifications.
- If you are installing new plumbing or making alterations to existing internal plumbing arrangements, you must ensure that the plumbing complies with the Water Supply (Water Fittings) Regulations 1999 and with United Utilities Water's specification for the purposes of ensuring it will be reasonably practicable to install and connect a meter.
- Where your development or property requires water to be delivered at a height greater than 10.5 metres below the draw off point of the reservoir or tower supplying the area it is a requirement, in accordance with Section 66 of the Water Industry Act 1991, that you install a cold water storage cistern to cover twenty-four hours demand.
- Any outstanding charges payable as a result of a disconnection notice or any charges payable for any outstanding compliance requirement from any Section 75 notice that has been served (waste, contamination or misuse) have been paid in full.

In addition to the statutory conditions above, if you have yet to provide us with a full postal address for the property/s to be connected, please remember that we will need this information before we can make any service connection/s. If you have not yet obtained or agreed this information with your local planning authority, we strongly recommend that you contact your planning representative as soon as possible to prevent your connection being delayed later on in the process.

Scale Approx : 3500



United Utilities
helping life flow smoothly

From: Yates, Rachel <Rachel.Yates@uuplc.co.uk>

Sent: 16 August 2019 11:56

To: angela.brown@t-d-s.com

Subject: FW: FAO Jenny Smith Pre development enquiry Response - Former New Hey Quarry, Rochdale - 4100394429

Angela,

As discussed earlier. The rules regarding reinforcement being funded by the infrastructure pot if the passing main is of sufficient size only apply to distribution mains and the 18" main is a trunk main. The rules also only apply if the development can be gravity fed. This development is at a very similar level to the treatment works that will supply it so it may not be able to be gravity fed. If this is the case the cost of the pumps/booster etc would be rechargeable to the developer.

Thank you

Rachel

Rachel Yates

Project Design Engineer - Central Area

Wholesale- Developer Services Water

United Utilities

T: 0345 072 6067

M: 07747 446679 (mobex 56963)

unitedutilities.com

If you have received a great service today why not tell us?

Visit: unitedutilities.com/wow



From: Angela Brown [<mailto:angela.brown@t-d-s.com>]

Sent: 13 August 2019 16:09

To: StatutoryWater <StatutoryWater@uuplc.co.uk>

Subject: FAO Jenny Smith Pre development enquiry Response - Former New Hey Quarry, Rochdale - 4100394429

Importance: High

Hi Jenny,

Thanks for your email below.

Just a query though please, in your email below, you have advised that "Due to the POC being a trunk main and not a distribution main these charges will be at the developers cost". Are you saying that a connection cannot be made off a trunk main?

Thanks.

Regards.

Angela.

From: StatutoryWater <StatutoryWater@uuplc.co.uk>

Sent: 24 July 2019 14:02

To: angela.brown@t-d-s.com

Subject: RE: FAO Jenny Smith Pre development enquiry Response - Former New Hey Quarry, Rochdale - 4100394429

Importance: High

Good Afternoon Angela

Further to our emails below, we have had discussions with our network engineer and they have asked for the following information from you in order to provide us with what reinforcement works are going to be required:

- Site Layout plans showing properties location and any changes to the existing ground levels – This is required to assess the height difference between this development and the treatments works which will be supplying this development.

Once you have provided the above further information we can take this back to our network team to model this and confirm the extent of these reinforcement works in order to allow us to provide you with costs.

Due to the POC being a trunk main and not a distribution main these charges will be at the developers cost.

Regards

Jenny Smith

Assistant Developer Engineer

Developer Services

Network Delivery

United Utilities
T: 0345 072 6067
unitedutilities.com

If you have received a great service today why not tell us?
Visit: unitedutilities.com/wow